

Tainted Expansion Organizer

LTTGS

Compatible with Tainted Grail
Age of Legends & Last Knight
and Red Death expansions

This organizer was designed to hold all Tainted Grail 2 wave content in the Tainted Grail:
Stretch Goal box. This product is not licensed, and is up for change at any time in the future.

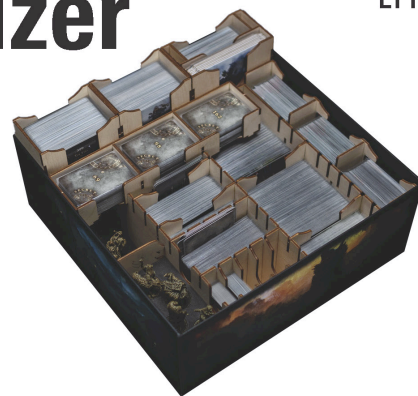
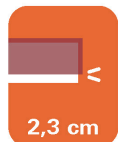

Assembly Guide



LASEROX



Watch our beginners
guide videos on
youtube.
Just scan the
QR code and get
started!

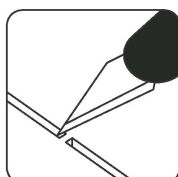

Use an exacto
knife to cut the
bits connecting
the parts to the
frame.

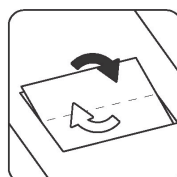

Remove the parts
from the frame
with a rotating
motion along the
axis formed by the
bits you just cut.

Use **wood glue** for assembly.
Always dry fit the parts first to
make sure the components are
correct ones. If you encounter
any issues, please contact us at
info@laserox.net or our
Facebook page at
facebook.com/laseroxinserts.

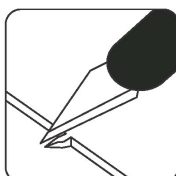

Use the exacto
knife to remove
any of the
remaining
connection bits.

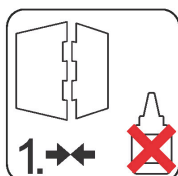

Always dry-fit the
parts to together
without any glue
to make sure you
are assembling the
correct parts.



Use a drop of glue
along the joints
and press the parts
together or use a hobby
hammer with slight
force for assembly.



WARNING Choking hazard!
Not for children under 14 years.

Part numbers

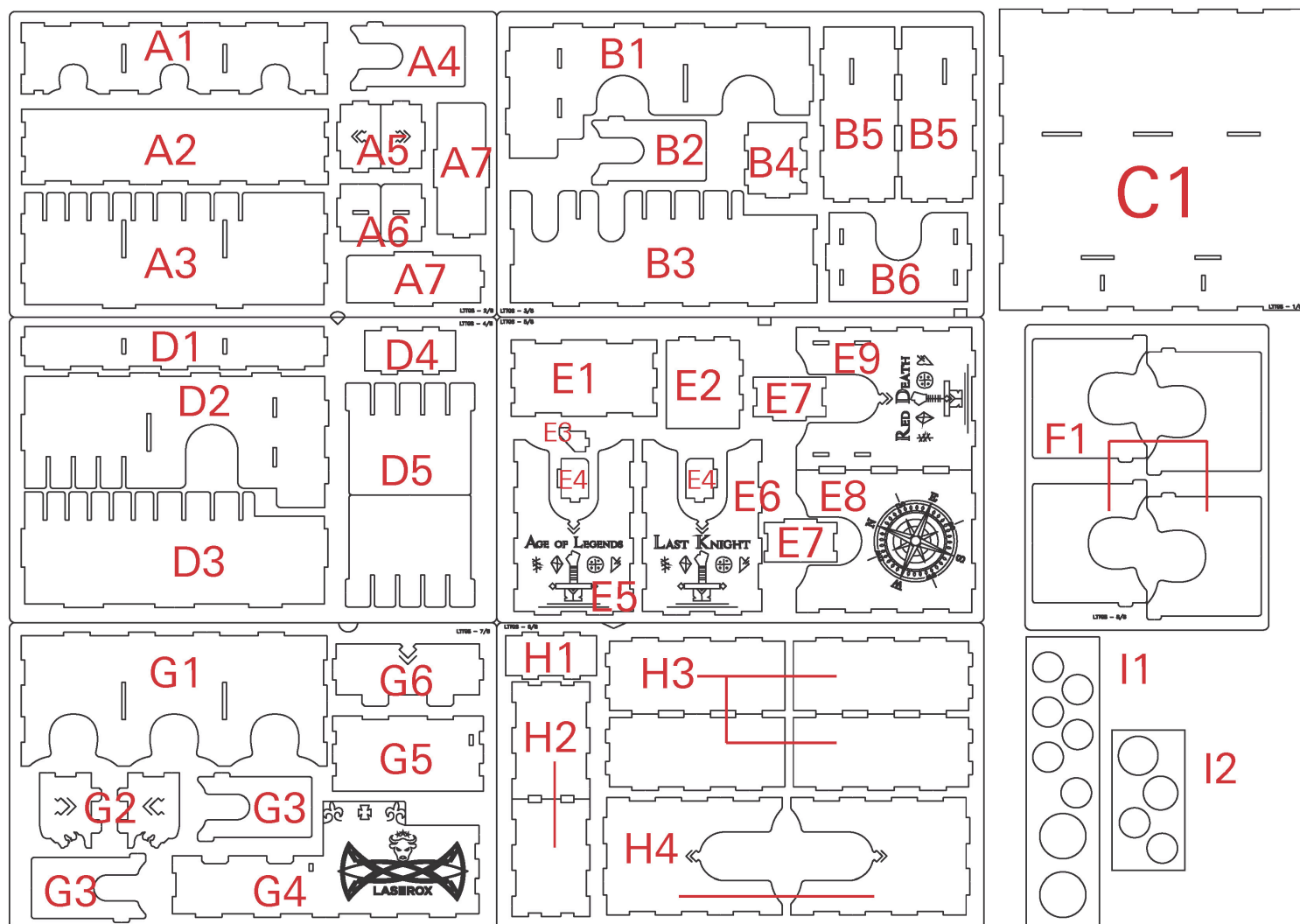

Part 1. Round Tiles

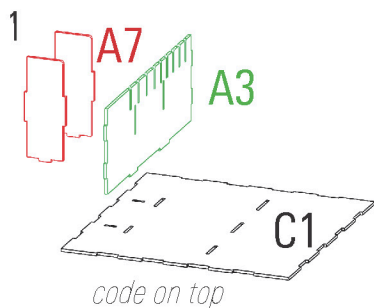

Required parts: **A7x2, A3, C1, G1, D3, B1, D2, B3, G3x2/A4, D5x2, F1**

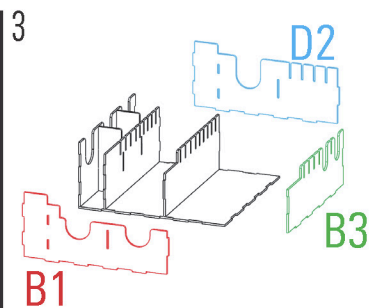
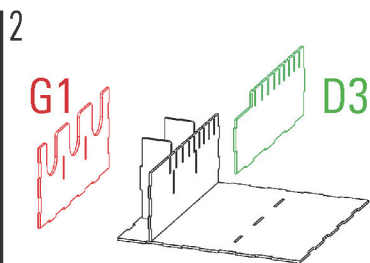

Part 1. Player Parts

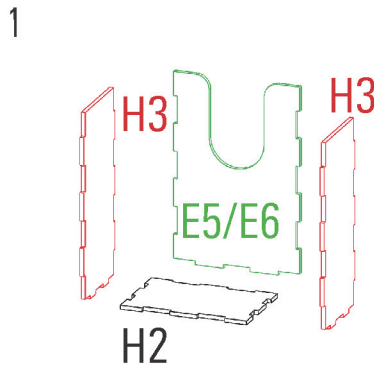

Required parts: **H2, E5/E6, H3x2, H4**

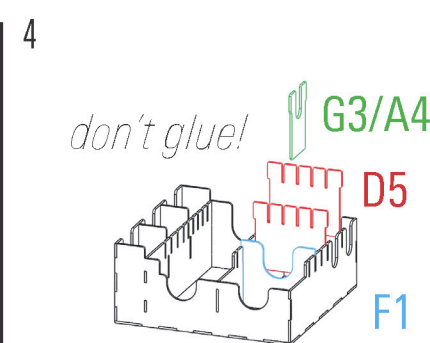
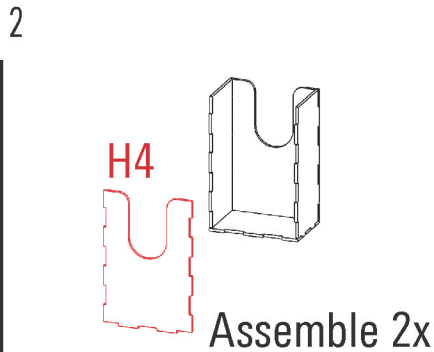

Part 1. Token box

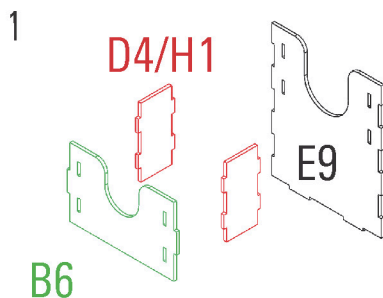

Required parts: **B6, E9, D4/H1, B5x2, E1, E8**

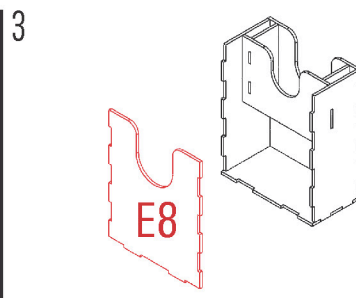
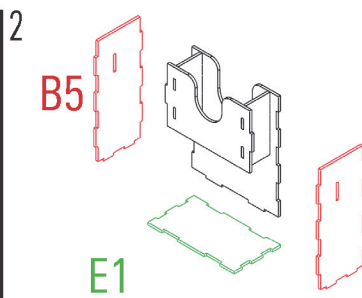

Part 1. Buildings

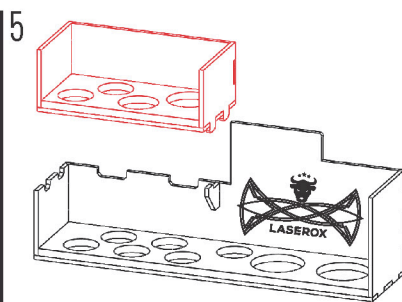
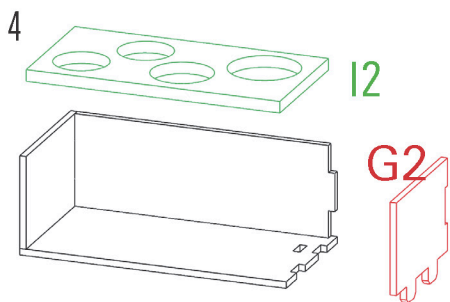
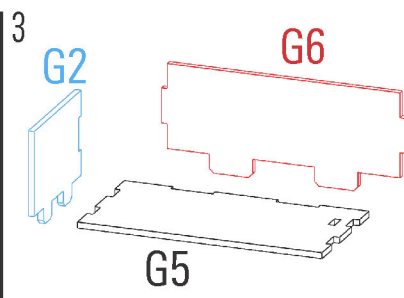
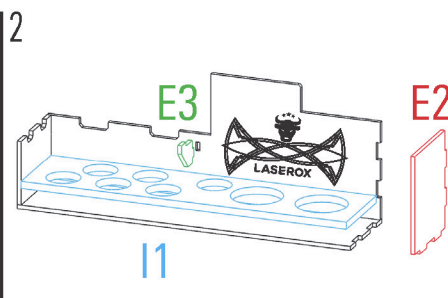
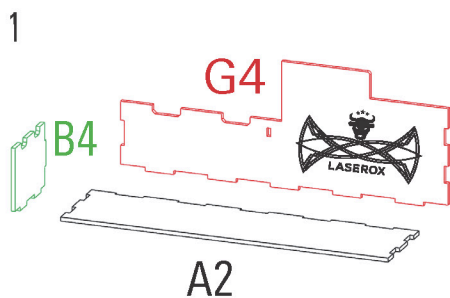

Required parts: **A2, B4, G4, I1, E3, E2, G2, G6, G5, G2x2, I2**

Part 1. Round Tiles

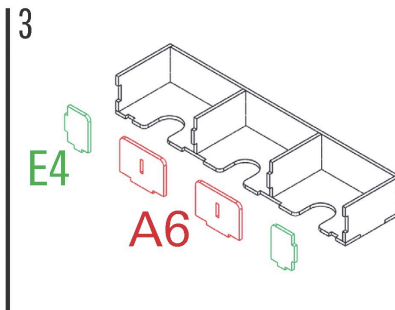
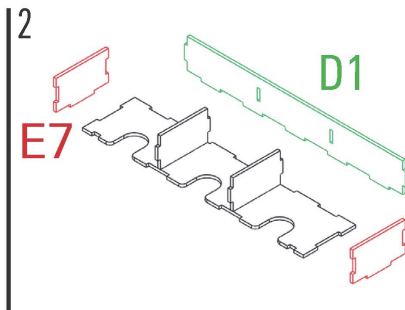
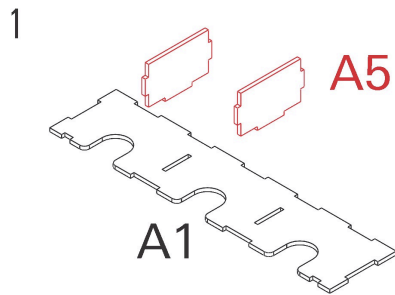

Required parts: **A1, A5x2, E7x2, D1, E4x2, A6x2**

Assembly

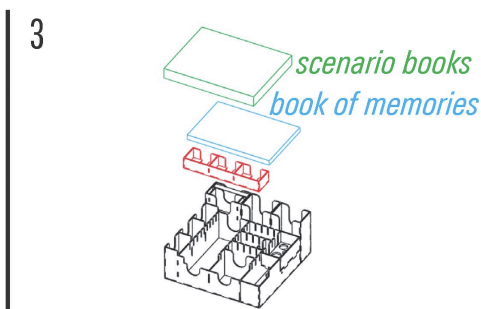
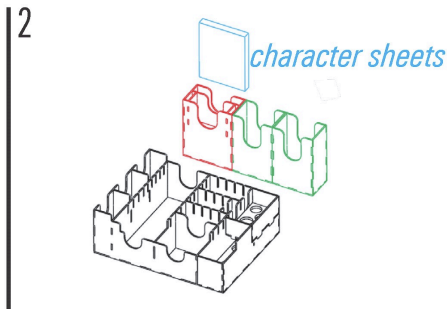
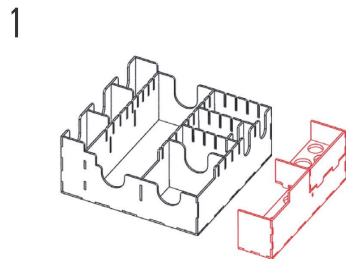

Part numbers: (copy of the 1st page just for easier handling)

