

# Twilight Treasury

LT14PK

## Upgrade Kit

Compatible with TI4 - Prophecy of Kings

This product is not licensed, and is up for change at any time in the future.

## Assembly Guide



LASEROX

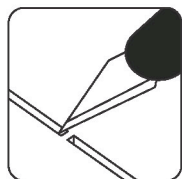

Use an exacto knife to cut the bits connecting the parts to the frame.

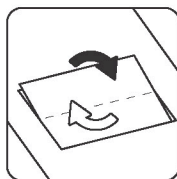

Remove the parts from the frame with a rotating motion along the axis formed by the bits you just cut.

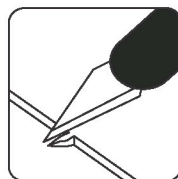

Use the exacto knife to remove any of the remaining connection bits.

Use **wood glue** for assembly. Always dry fit the parts first to make sure the components are correct ones. If you encounter any issues, please contact us at [info@laserox.net](mailto:info@laserox.net) or our Facebook page at [facebook.com/laseroxinserts](https://facebook.com/laseroxinserts).

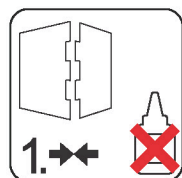

Always dry-fit the parts to together without any glue to make sure you are assembling the correct parts.



Use a drop of glue along the joints and hold it in place until the glue has sufficiently dried.

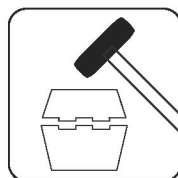

Press the parts together or use a hobby hammer with slight force for assembly.



**WARNING** Choking hazard!  
Not for children under 3 years.

## Part numbers

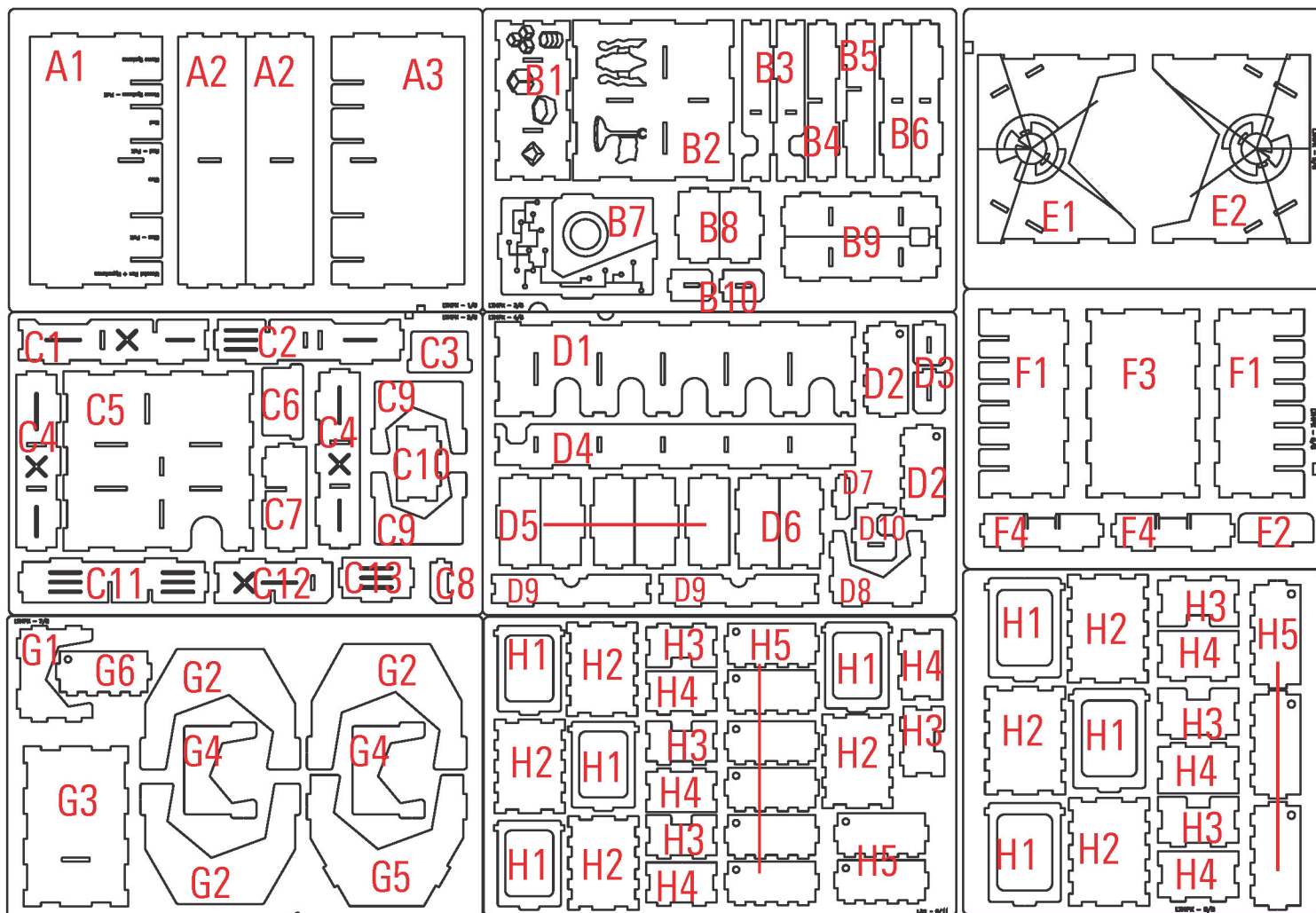

## Hex holder

Required parts: **B7,D9x2,F2,F4x2,G3**

Required parts: **C9x4,D8,F1x2,F3,G1,G4x2**

Required parts: **B10x2,D1,D3x2,D4,D5x5,D6x2,D7,D10**

Required parts: **D2x2,G6,H1x7,H2x7,H3x7,H4x7,H5x11**

Required parts: **A1,A2x2,A3,E1,E2,G2x3,G5**

3



DON'T GLUE!  
B7

3

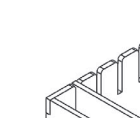
An isometric line drawing of a 3D-printed rectangular box. The box has a base and four vertical walls. Inside the box, there are several vertical dividers that create multiple compartments. The dividers are of varying heights, with some reaching the top of the box and others being shorter. The drawing is shown from a perspective that highlights the depth and the internal structure of the box.

3

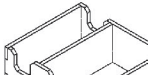
An isometric line drawing of a 5-bay DIN rail terminal block. The block is shown from a perspective view, highlighting its profile and the five individual terminal bays. Each bay has a vertical terminal post on its front face. The block is designed to be mounted onto a standard DIN rail.

3

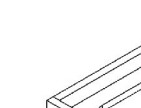

## Assemble 7x

3



G2 DON'T GLUE!



Laserox Design Ltd.  
H-2092 Budakeszi  
Tiefenweg way 39



## Player parts

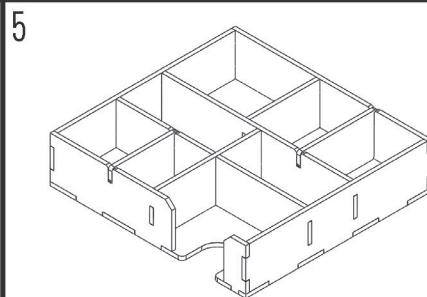
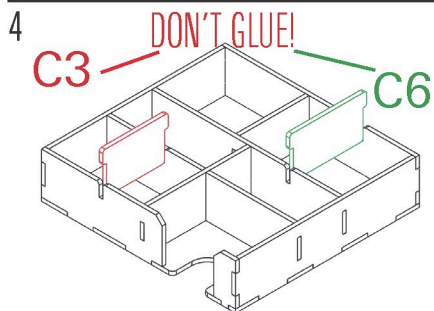
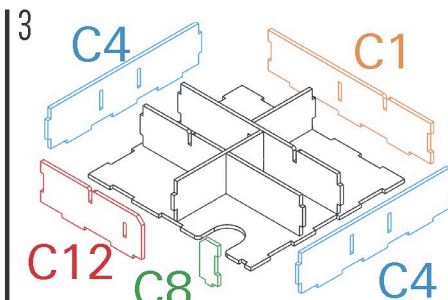
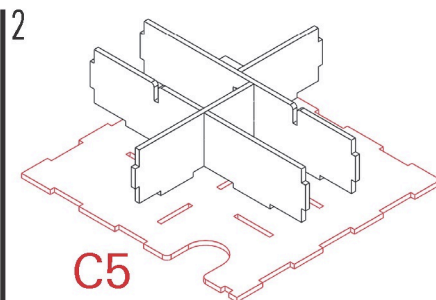
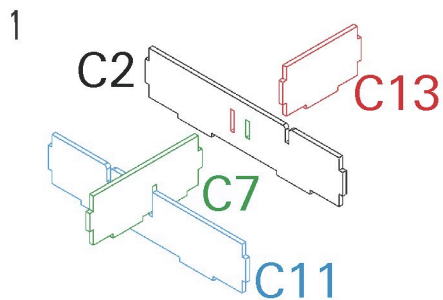

## Assemble 2x

Required parts: **C1,C2,C3,C4x2,C5,C6,C7,C8,C11,C12,C13**

## Token tray

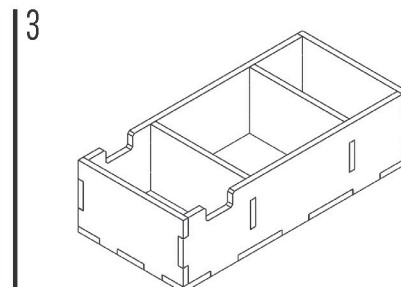
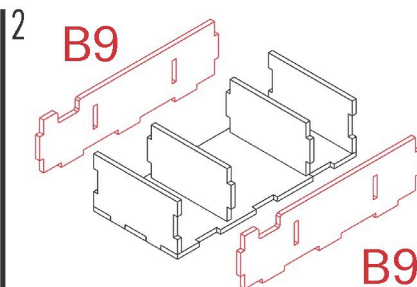
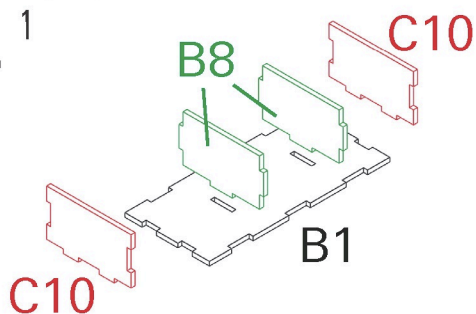

Required parts: **B1,B8x2,B9x2,C10x2,**



## Token tray 2

1

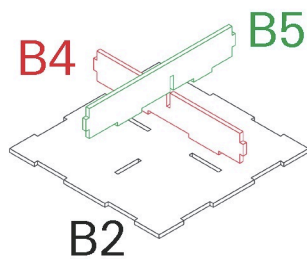

2

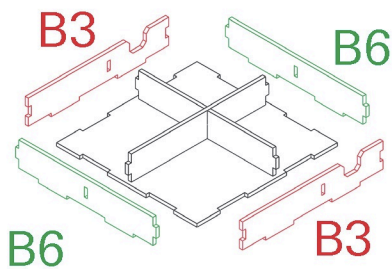

3

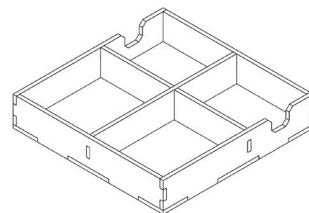

LTI4PK II

Required parts: **B2,B3x2,B4,B5,B6x2**

## Assembly

1

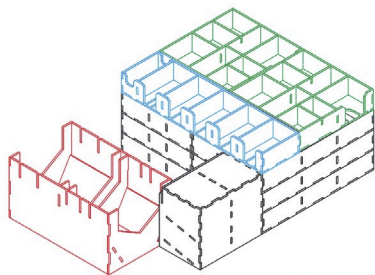

Replace Map tile tray with Hex holder

2

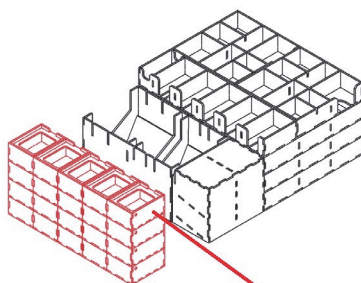

3

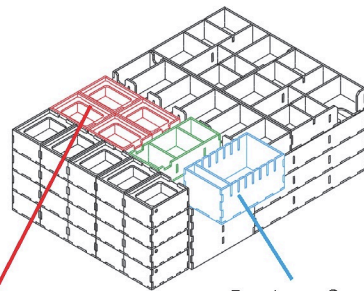

Replace Card tray

+7 Faction boxes

4

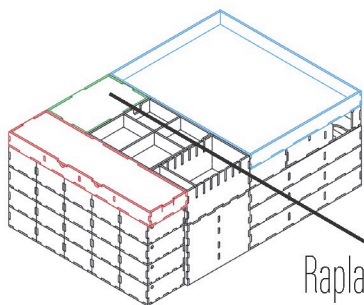

Replace Action Card tray