

# Rollganizer

## Compatible with Roll Player

and following expansion: RP: Monsters&Minions.

This product is not licensed, and is up for change at any time in the future.



## Assembly Guide



**LASEROX**

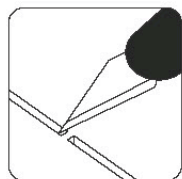

Use an exacto knife to cut the bits connecting the parts to the frame.

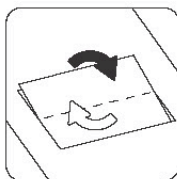

Remove the parts from the frame with a rotating motion along the axis formed by the bits you just cut.

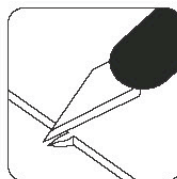

Use the exacto knife to remove any of the remaining connection bits.

Use **wood glue** for assembly. Always dry fit the parts first to make sure the components are correct ones. If you encounter any issues, please contact us at [info@laserox.net](mailto:info@laserox.net) or our Facebook page at [facebook.com/laseroxinserts](https://facebook.com/laseroxinserts).

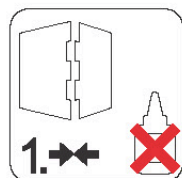

Always dry-fit the parts to together without any glue to make sure you are assembling the correct parts.

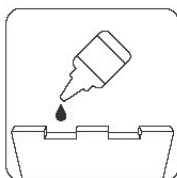

Use a drop of glue along the joints and hold it in place until the glue has sufficiently dried.

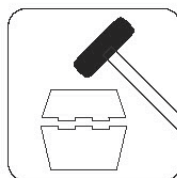

Press the parts together or use a hobby hammer with slight force for assembly.



**WARNING** Choking hazard!  
Not for children under 14 years.

## Part numbers

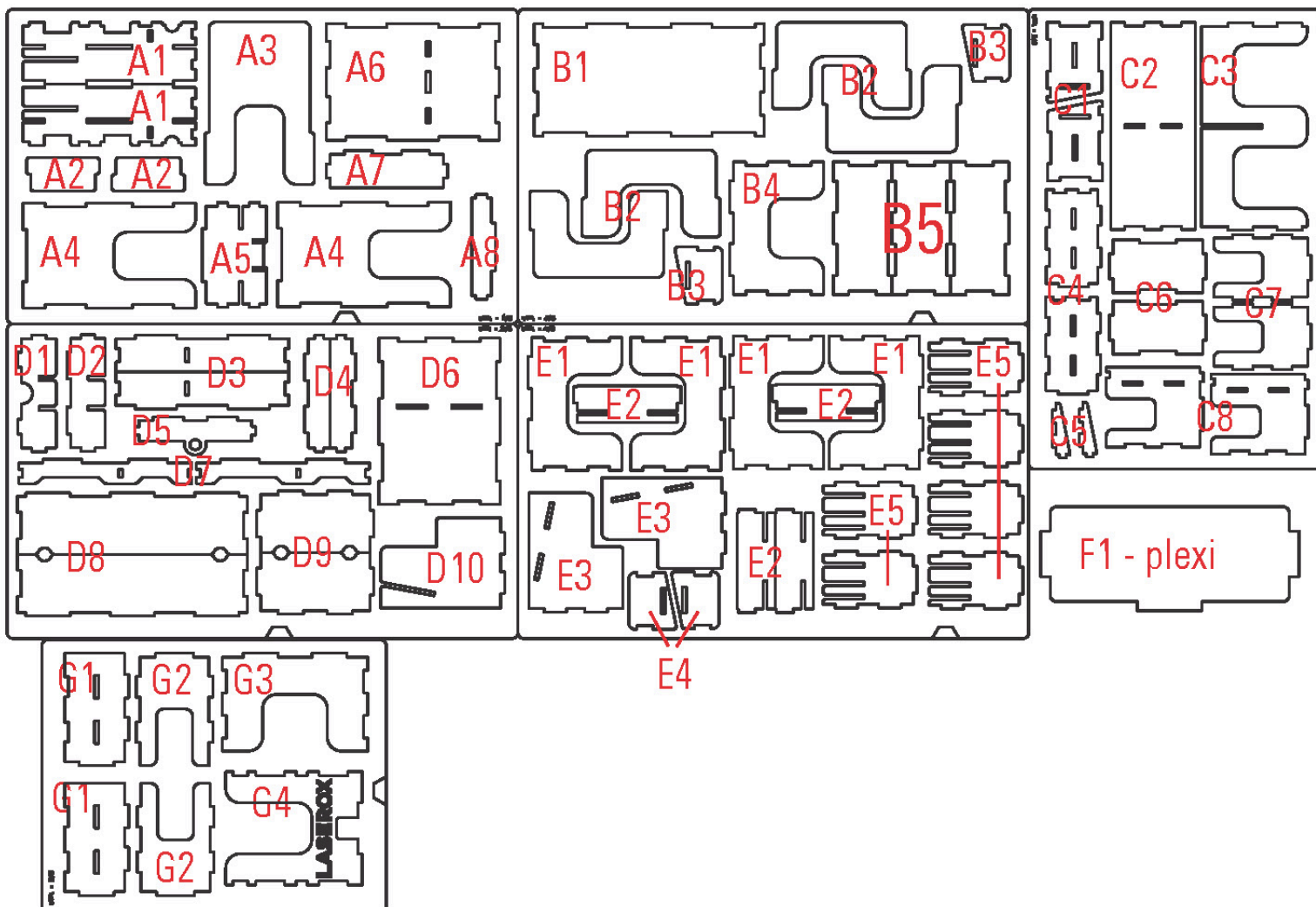

## Coin tray

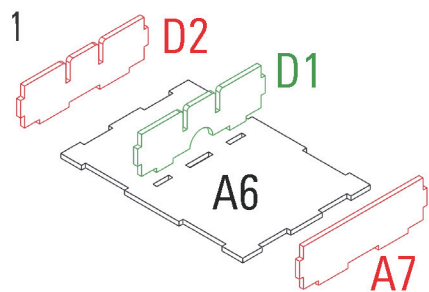

Required parts: **A2x2,A7,D1,D2,D3x2**

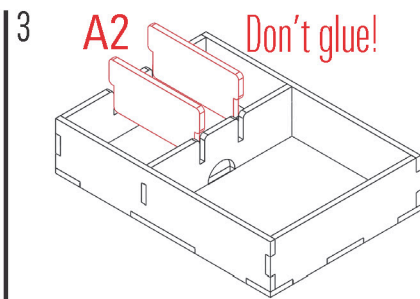
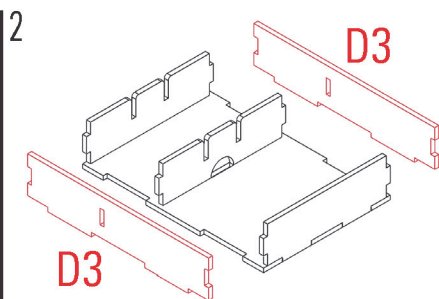

## Card holder

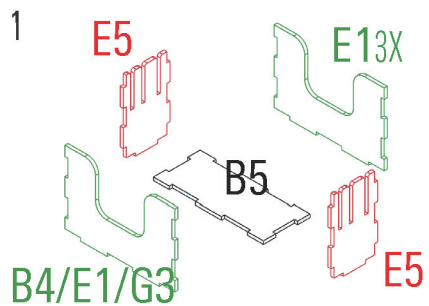

Required parts: **B2x4,B4,B5x3,E1x4,E5x6,G3**

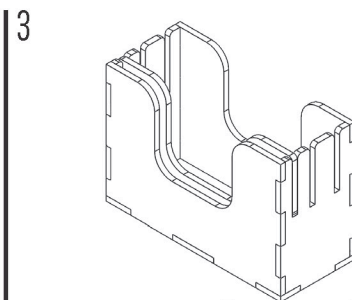
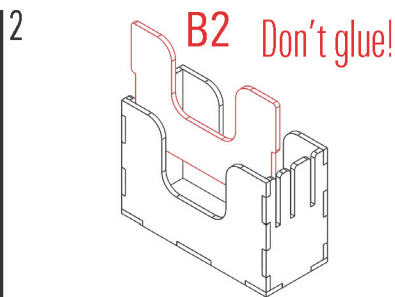

**Assemble 3x**

## Deck

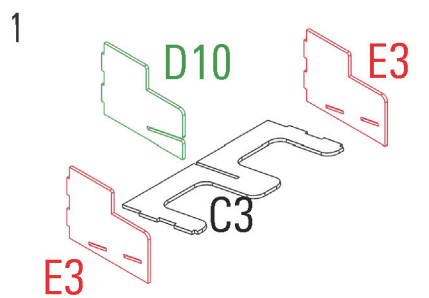

Required parts: **C2,C3,D10,E3x2**

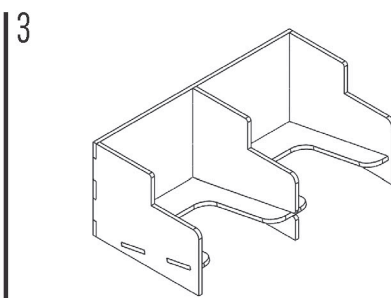
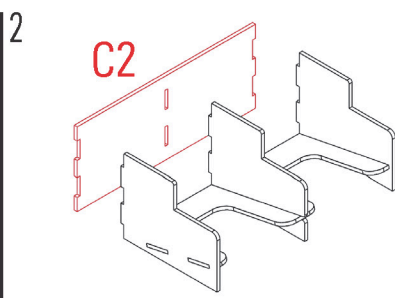

## Dice tray

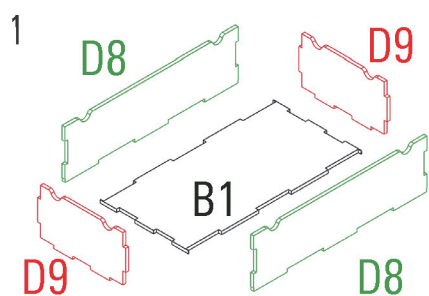

Required parts: **B1,D8x2,D9x2**

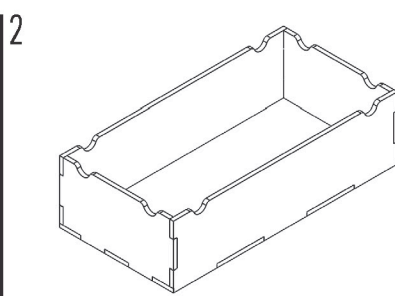

## Monster holder

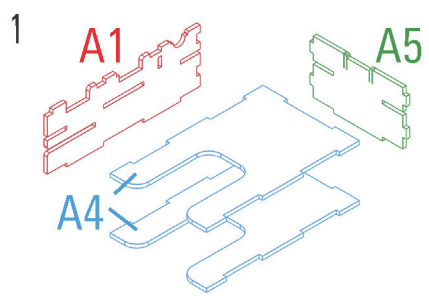

Required parts: **A1x2,A3,A4x2,A5,A8,F1,G4**

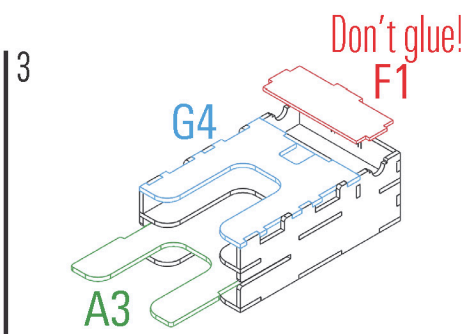
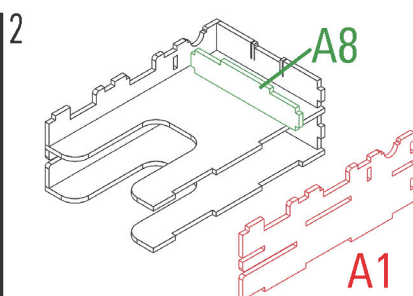

## Small Dice tray

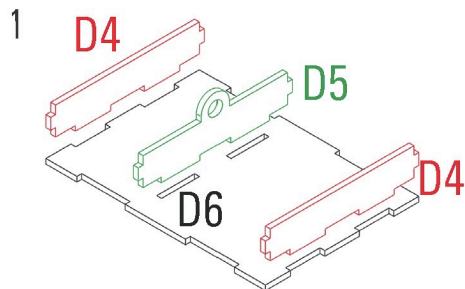

Required parts: **F4, F5, E5x2, E7, E8,**

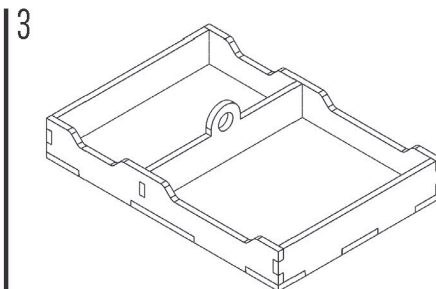
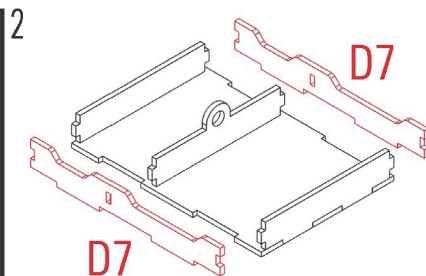

## S. card holder

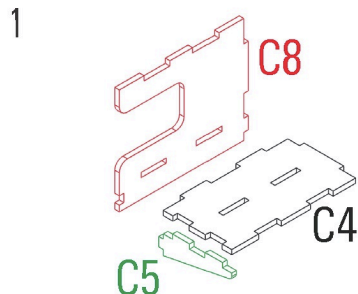

Required parts: **C1x2, C4x2, C5x2, C7x2, C8x2, G1x2, G2x2**

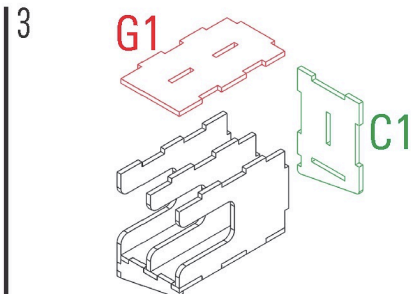
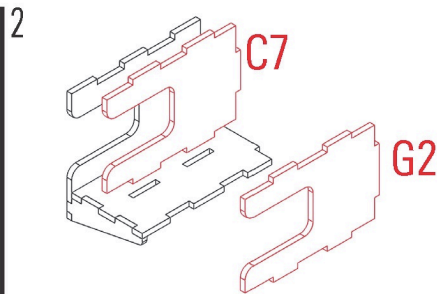

**Assemble 2x**

## S. token holder

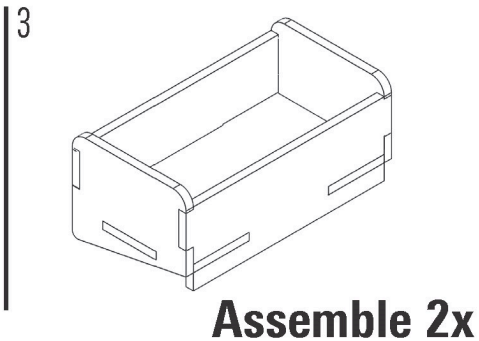
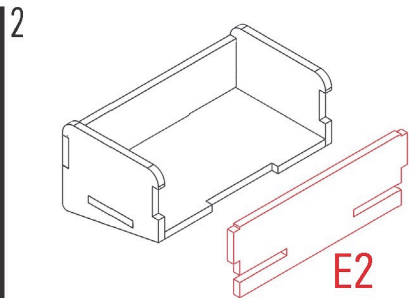
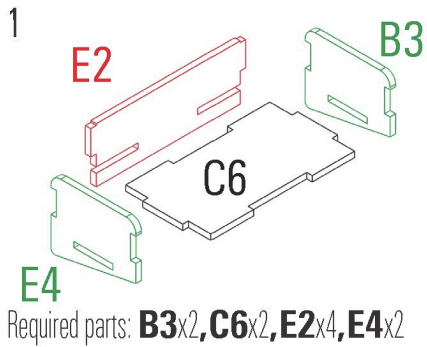

## Assembly

