

# Shinto Storage

Compatible with Rising Sun

Daimyo Box

This product is not licensed, and is up for change at any time in the future.



## Assembly Guide



LASEROX

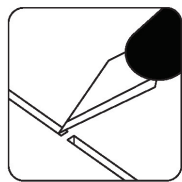

Use an exacto knife to cut the bits connecting the parts to the frame.

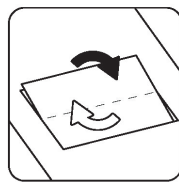

Remove the parts from the frame with a rotating motion along the axis formed by the bits you just cut.

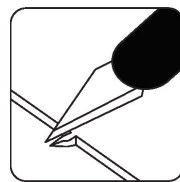

Use the exacto knife to remove any of the remaining connection bits.

Use **wood glue** for assembly. Always dry fit the parts first to make sure the components are correct ones. If you encounter any issues, please contact us at [info@laserox.net](mailto:info@laserox.net) or our Facebook page at [facebook.com/laseroxinserts](https://www.facebook.com/laseroxinserts).

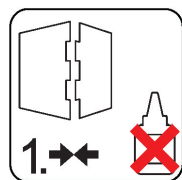

Always dry-fit the parts to together without any glue to make sure you are assembling the correct parts.



Use a drop of glue along the joints and hold it in place until the glue has sufficiently dried.

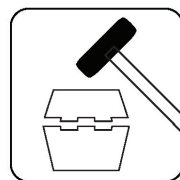

Press the parts together or use a hobby hammer with slight force for assembly.



**WARNING** Choking hazard!  
Not for children under 14 years.

## Part numbers

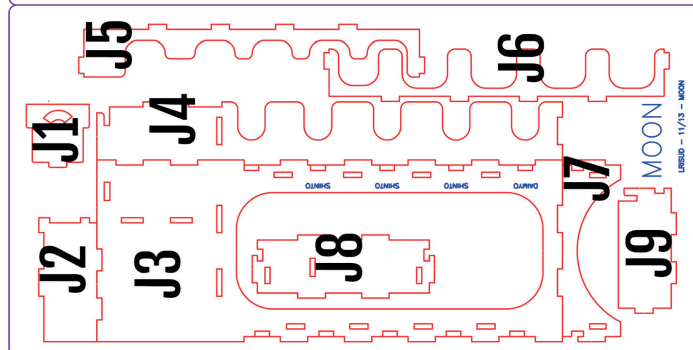
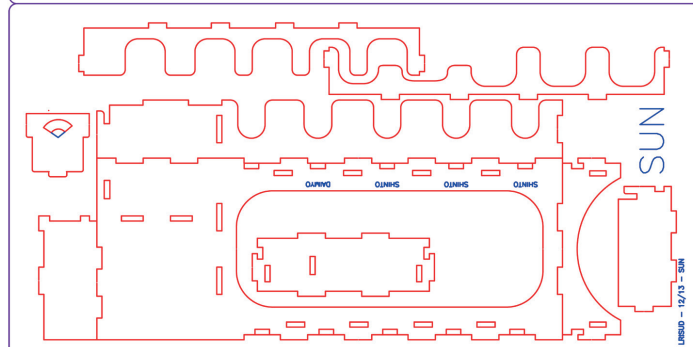
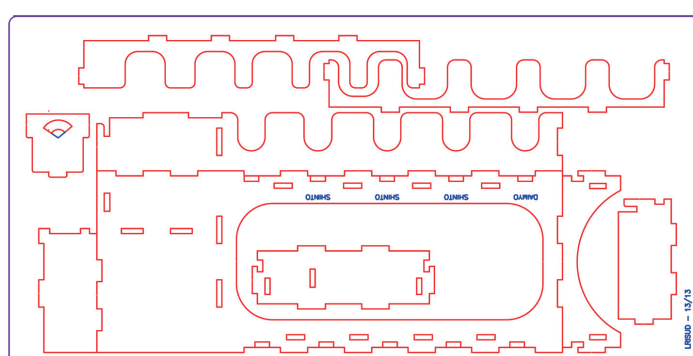
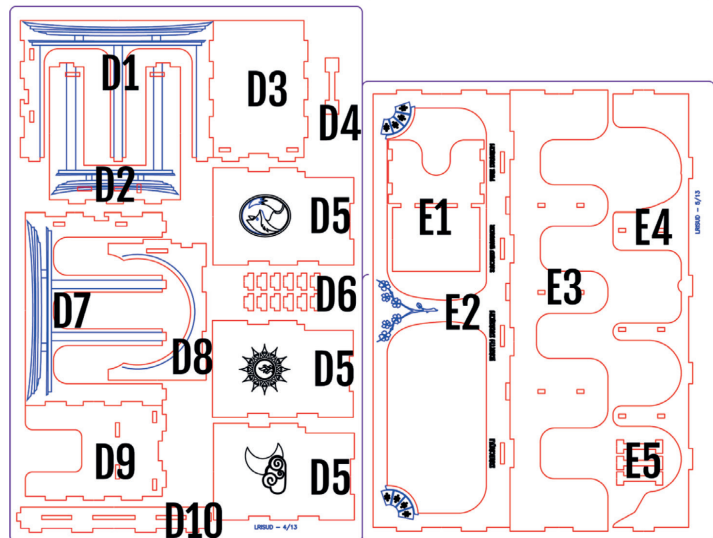
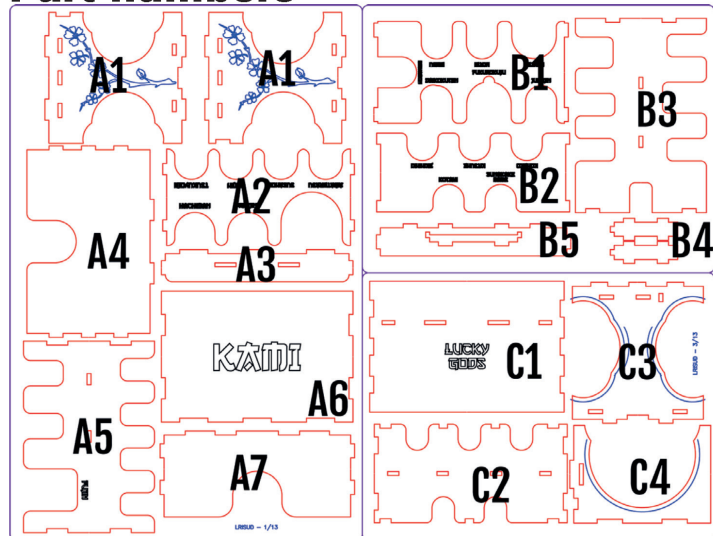

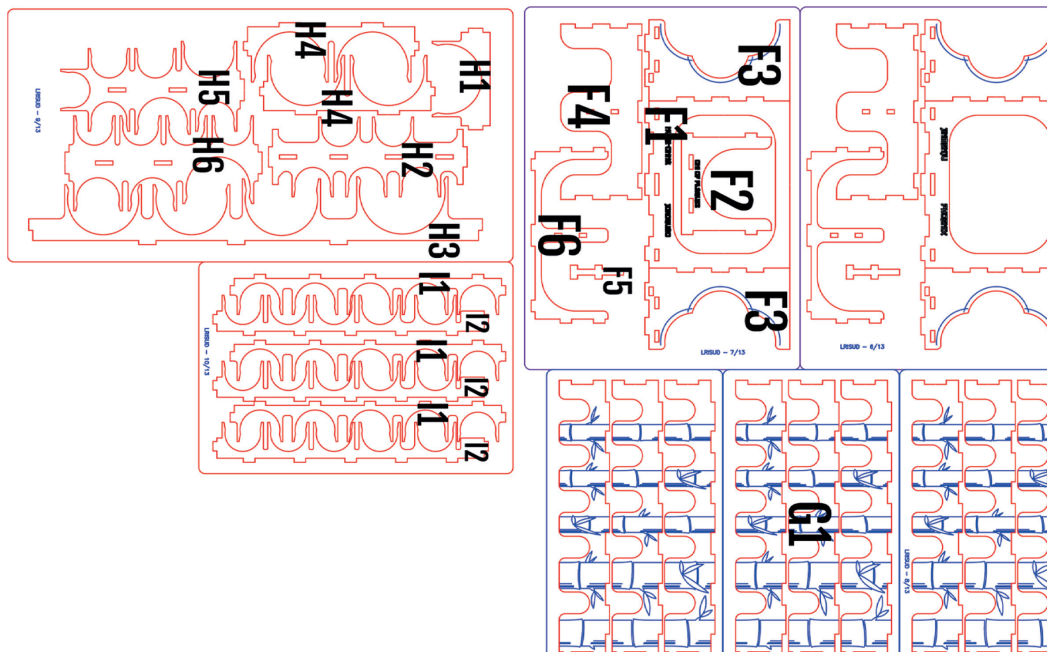

## Lucky gods

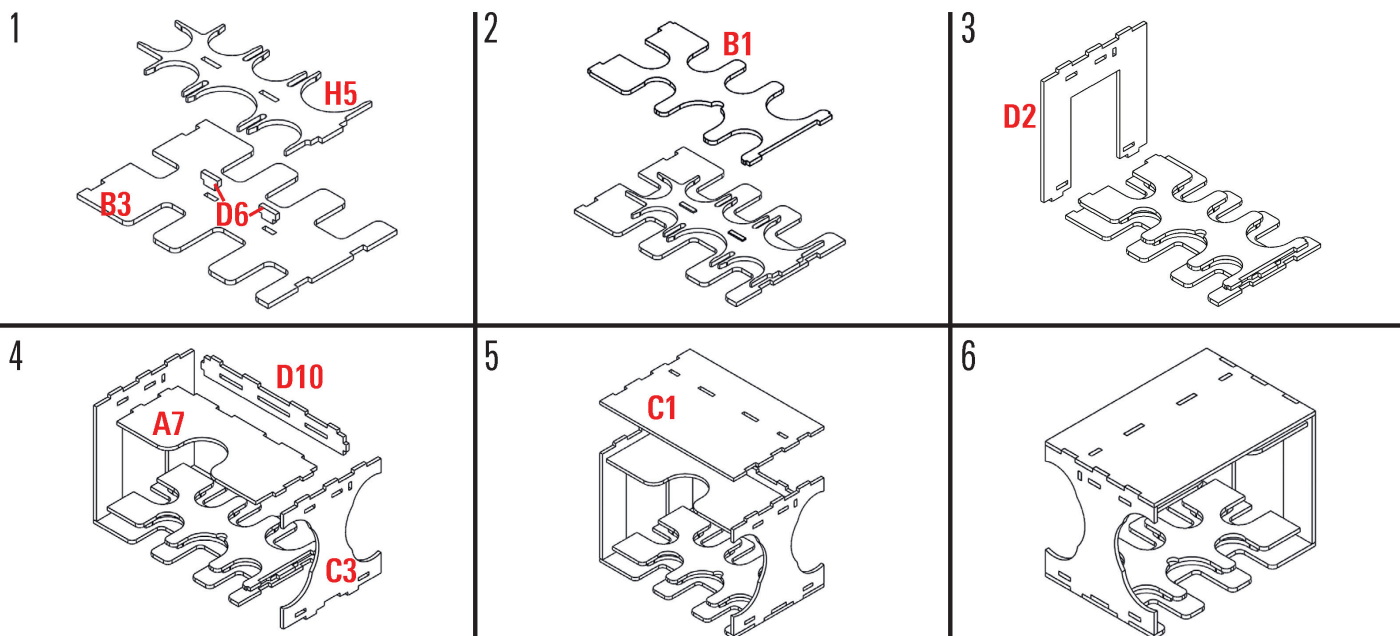

Required parts: **A7,B1,B3,C1,C3,D2,D6x2,D10,H5**

## Small monsters

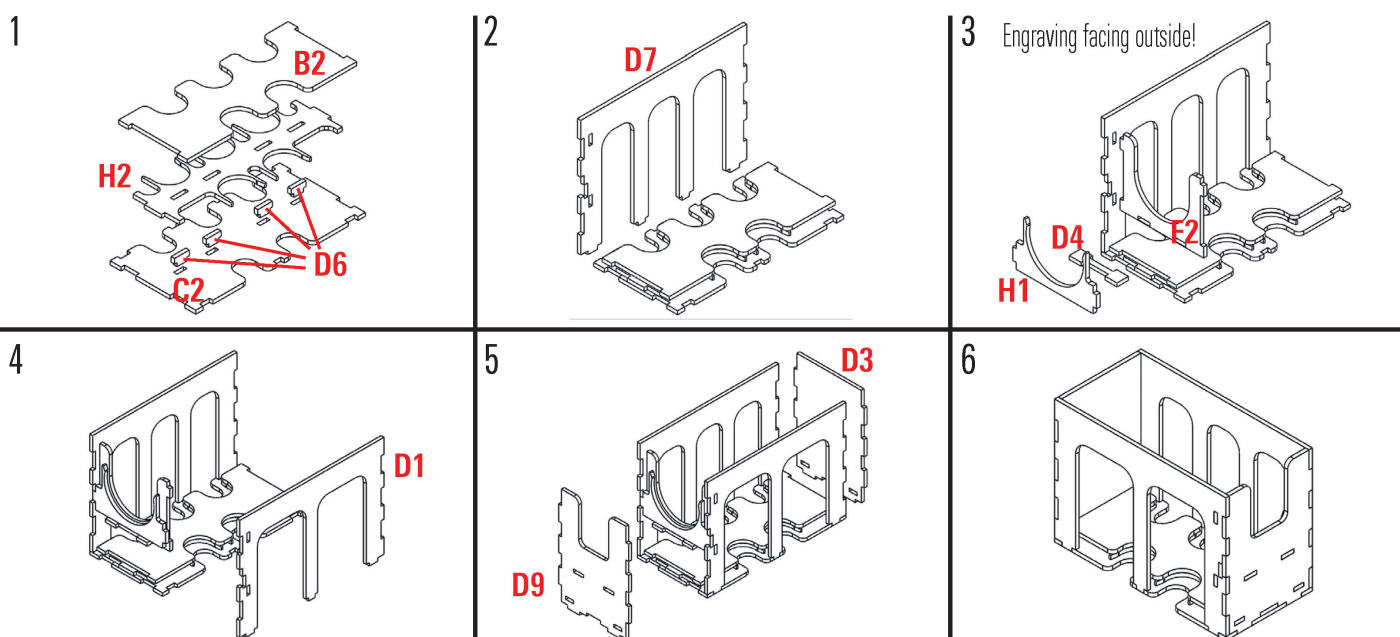

Required parts: **B2,C2,D1,D3,D4,D6x4,D7,D9,F2,H1,H2**

## Clan trays

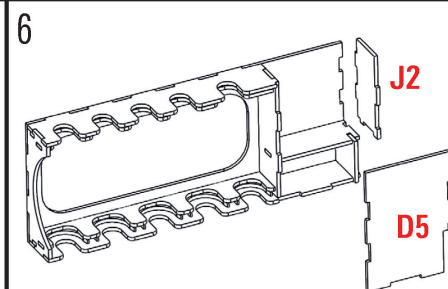
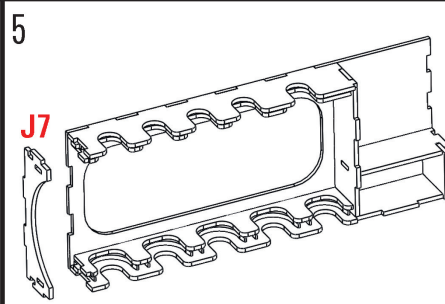
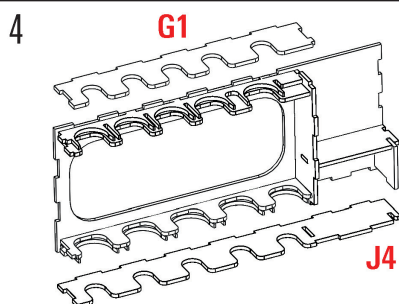
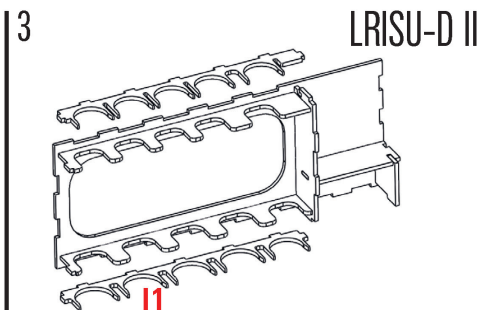
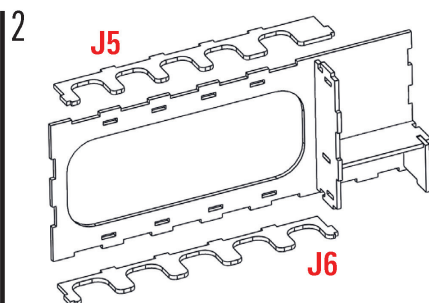
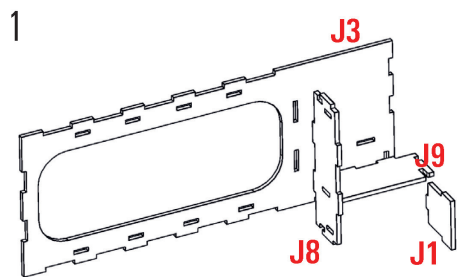

### Assemble 3x

Look for the respective clan wood sheet (MOON,SUN) and use the appropriate D5 element!

Required parts: D5,G1,I1,I2,J1,J2,J3,J4,J5,J6,J7,J8,J9

## Kami

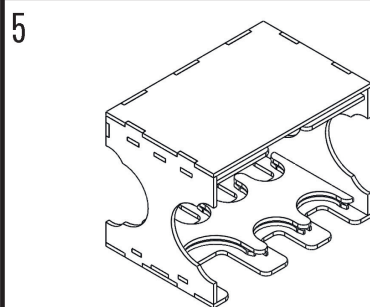
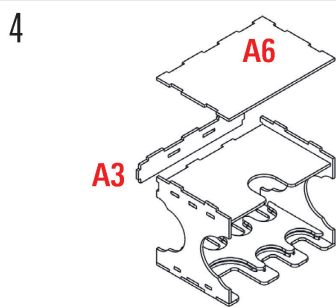
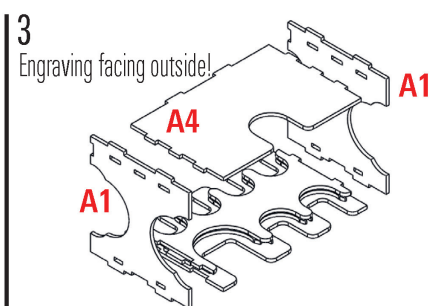
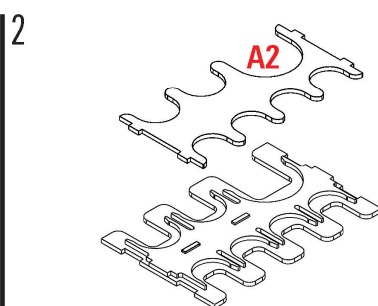
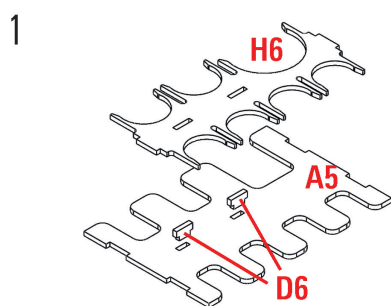

Required parts: A1x2,A2,A3,A4,A5,A6,D6,H6

## Monsters

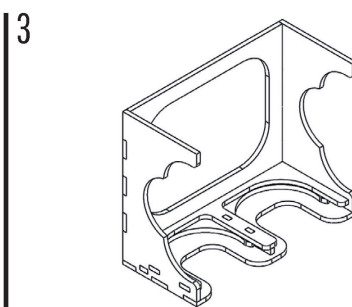
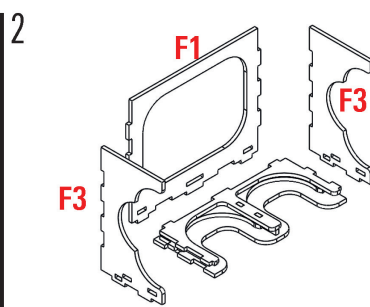
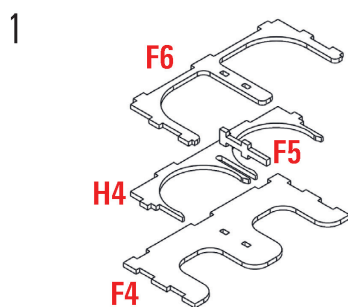

### Assemble 2x

Required parts: F1,F3x2,F4,F5,F6,H4



# Big monster tray

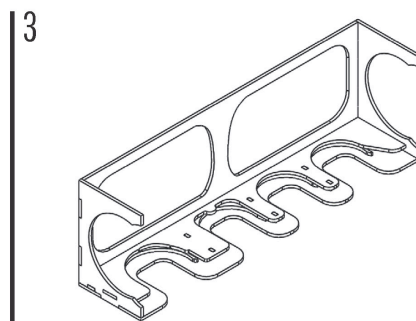
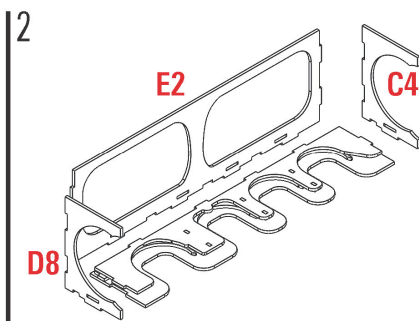
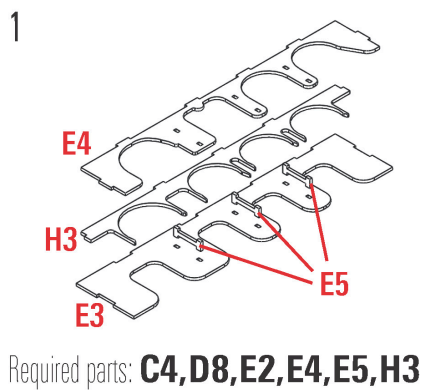

## Assembly

