

# Praga Organizer

LPRA

## Compatible with Praga Caput Regni

This product is not licensed, and is up for change at any time in the future.



## Assembly Guide



LASEROX



Watch our beginners guide videos on youtube. Just scan the QR code and get started!

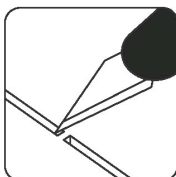

Use an exacto knife to cut the bits connecting the parts to the frame.

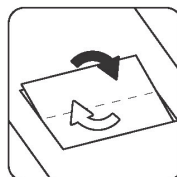

Remove the parts from the frame with a rotating motion along the axis formed by the bits you just cut.

Use **wood glue** for assembly. Always dry fit the parts first to make sure the components are correct ones. If you encounter any issues, please contact us at [info@laserox.net](mailto:info@laserox.net) or our Facebook page at [facebook.com/laseroxinserts](https://facebook.com/laseroxinserts).

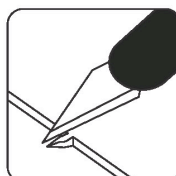

Use the exacto knife to remove any of the remaining connection bits.

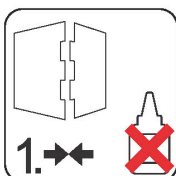

Always dry-fit the parts to together without any glue to make sure you are assembling the correct parts.

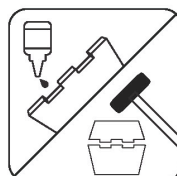

Use a drop of glue along the joints and press the parts together or use a hobby hammer with slight force for assembly.



**WARNING** Choking hazard!  
Not for children under 14 years.

## Part numbers

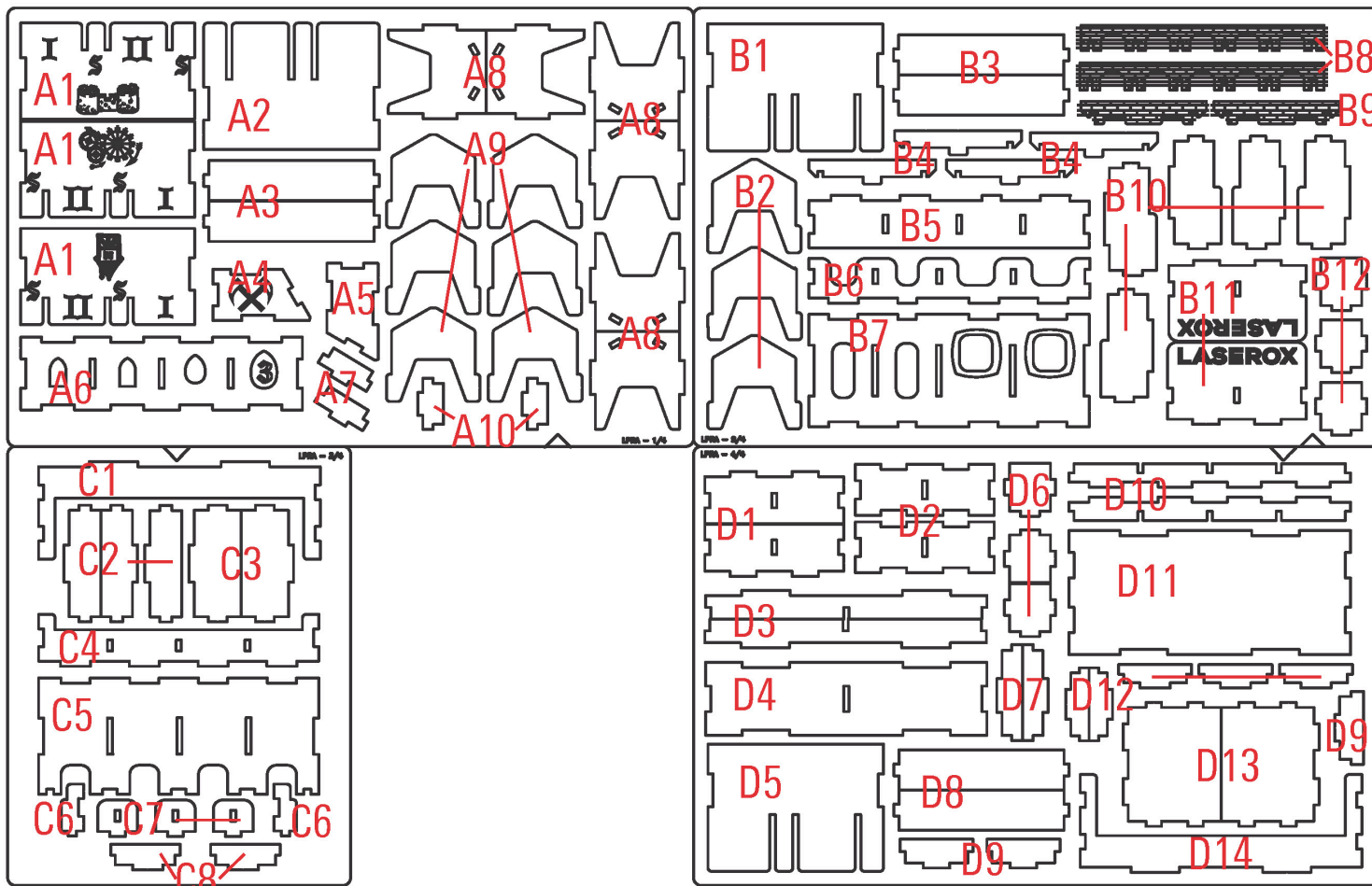

## Blue-Red tokens

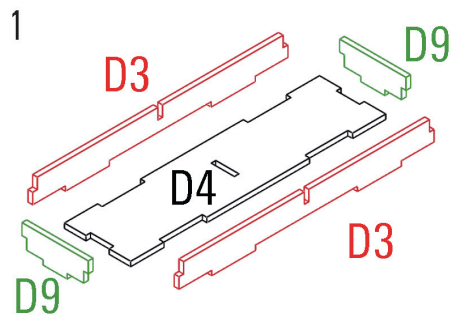

Required parts: **D3x2, D4, D9x3**

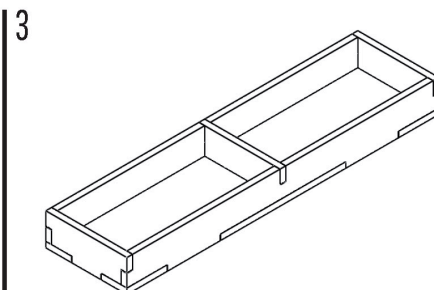
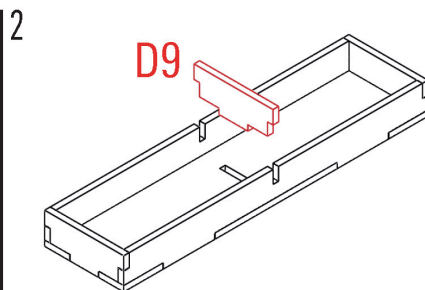

## Hex holder

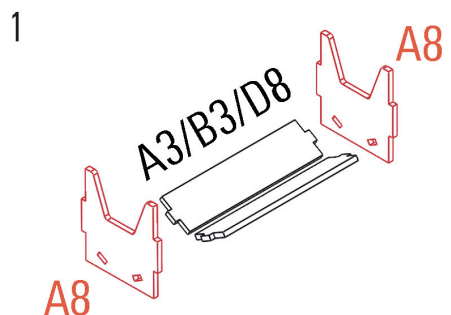

Required parts: **A1x2, A2, A3x2, A8x6, A9x6, B1, B2x3, B3x2, D5, D8x2**

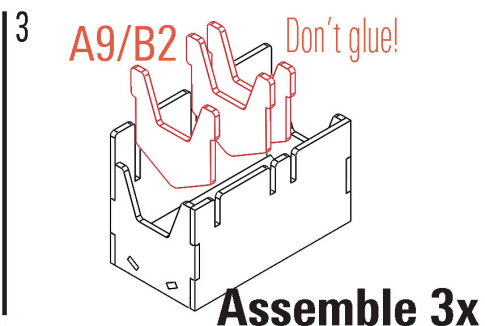
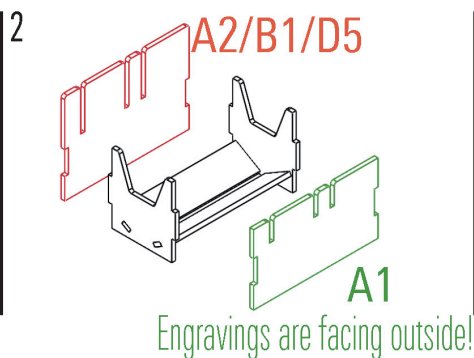

## Micro tokens

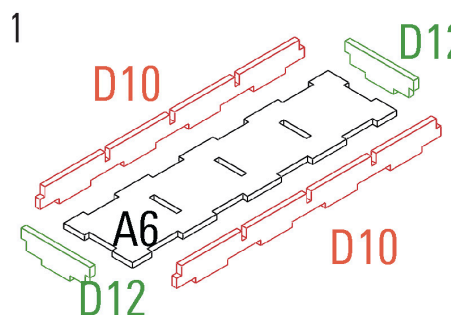

Required parts: **A6, D10x2, D12x5**

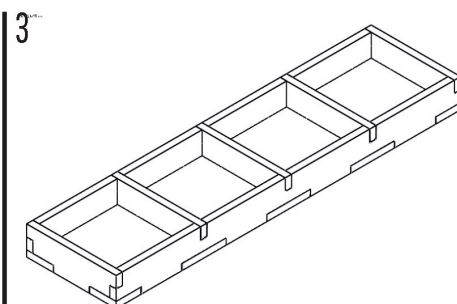
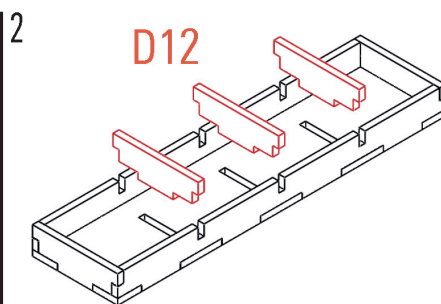

## Small holder

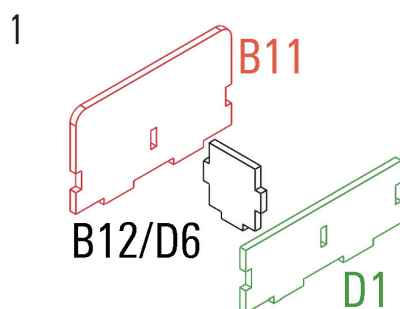

Required parts: **B11x2, B12x3, D1x2, D2x2, D6x3**

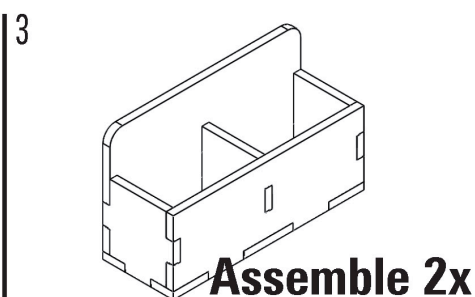
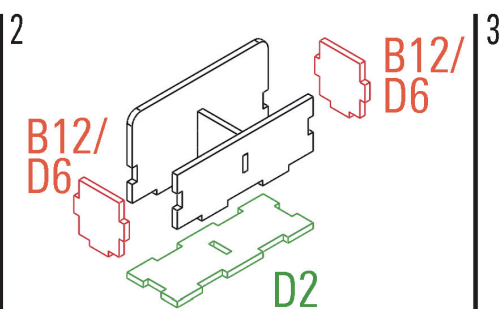

## Token holder

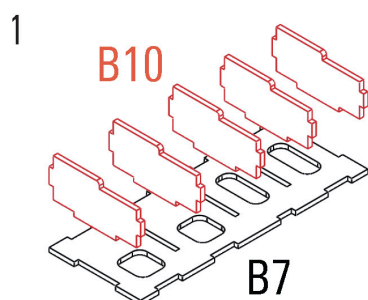

Required parts: **B5, B6, B7, B10x5**

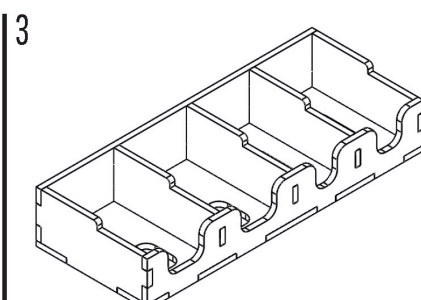
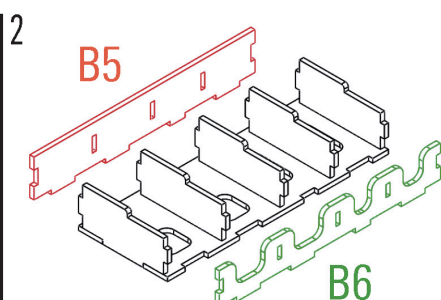

## Bridge

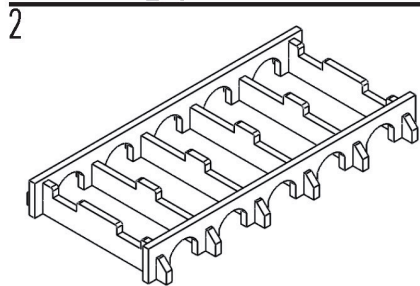
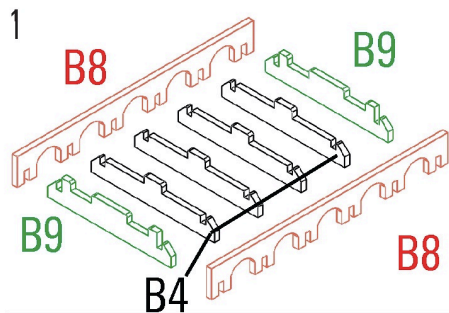

Required parts: **B4**×4, **B8**×2, **B9**×2

## Extra tray

Assemble 2 trays, they are mirror images of each other

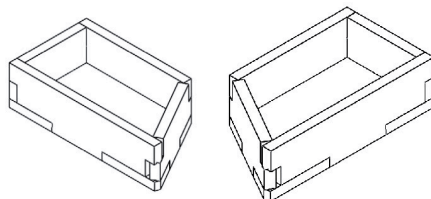
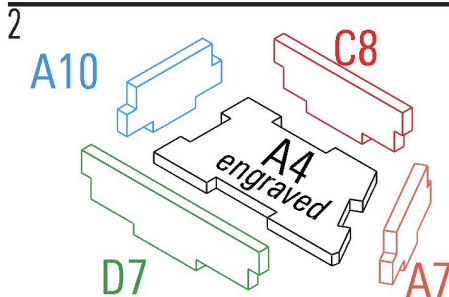
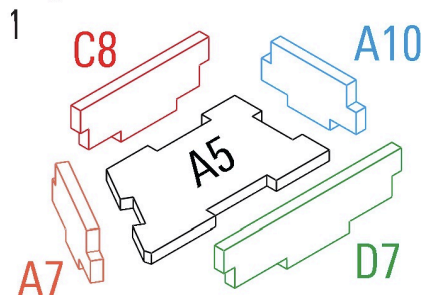

Required parts: **A4**, **A5**, **A7**×2, **A10**×2, **C8**×2, **D7**×2

## Large tray

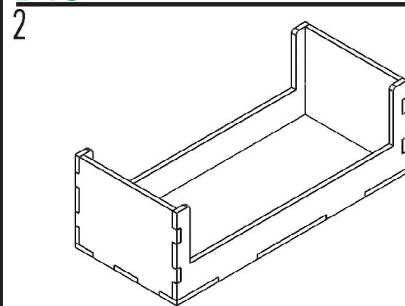
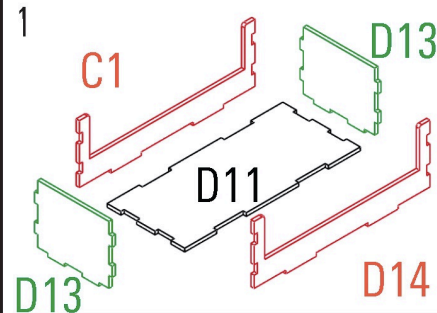

Required parts: **C1**, **D11**, **D13**×2, **D14**

**Assemble 2x**

# Token holder

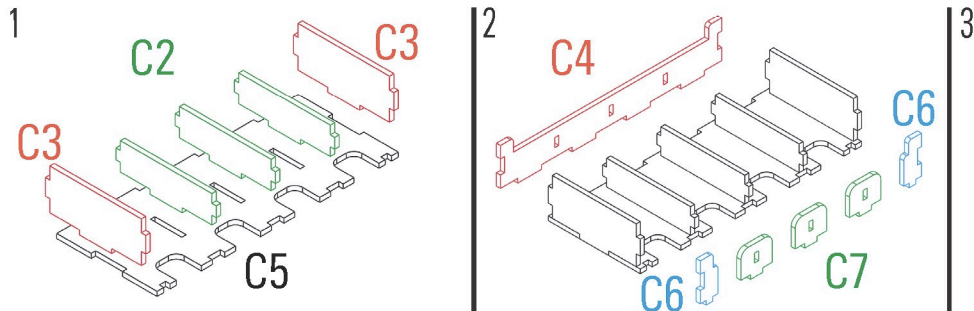

Required parts: **C2**×3,**C3**×2,**C4**,**C5**,**C6**×2,**C7**×3

# Assembly

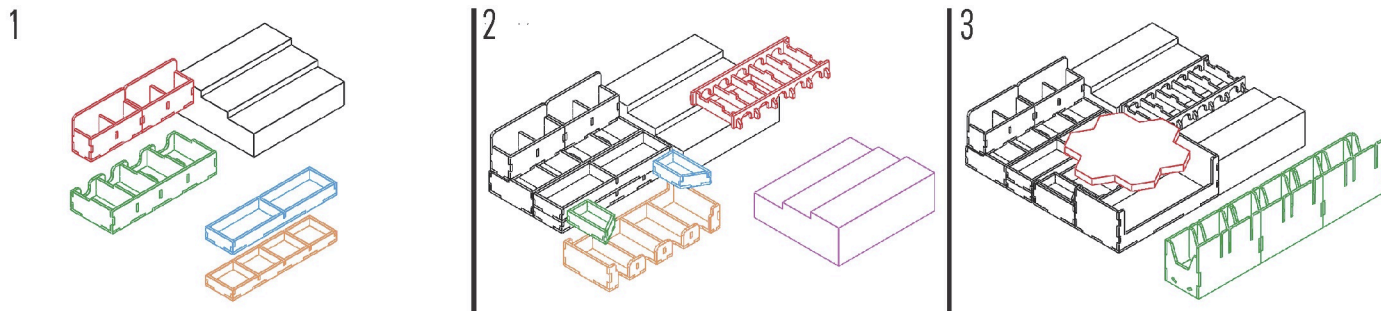

**LASEROX**

Laserox Design Ltd.  
H-2092 Budakeszi  
Tiefenweg way 39

