

Coffret de Tri Big Box

Compatible with Orléans®

and following expansions: Orléans: Fan-Kit,
Orléans: Invasion,
Orléans: Trade & Intrigue,
and various promos.

This product is licensed by dlp Games™, and is up for change at any time in the future.



LORLBB

Assembly Guide



LASEROX

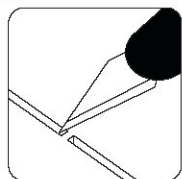

Use an exacto knife to cut the bits connecting the parts to the frame.

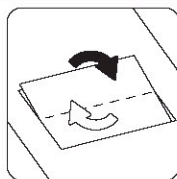

Remove the parts from the frame with a rotating motion along the axis formed by the bits you just cut.

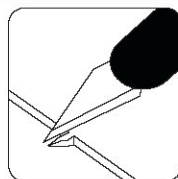

Use the exacto knife to remove any of the remaining connection bits.

Use **wood glue** for assembly. Always dry fit the parts first to make sure the components are correct ones. If you encounter any issues, please contact us at info@laserox.net or our Facebook page at facebook.com/laseroxinserts.

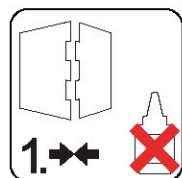

Always dry-fit the parts to together without any glue to make sure you are assembling the correct parts.

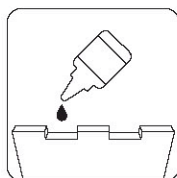

Use a drop of glue along the joints and hold it in place until the glue has sufficiently dried.

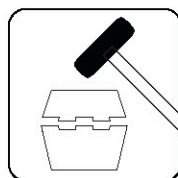

Press the parts together or use a hobby hammer with slight force for assembly.



WARNING Choking hazard!
Not for children under 14 years.

Part numbers

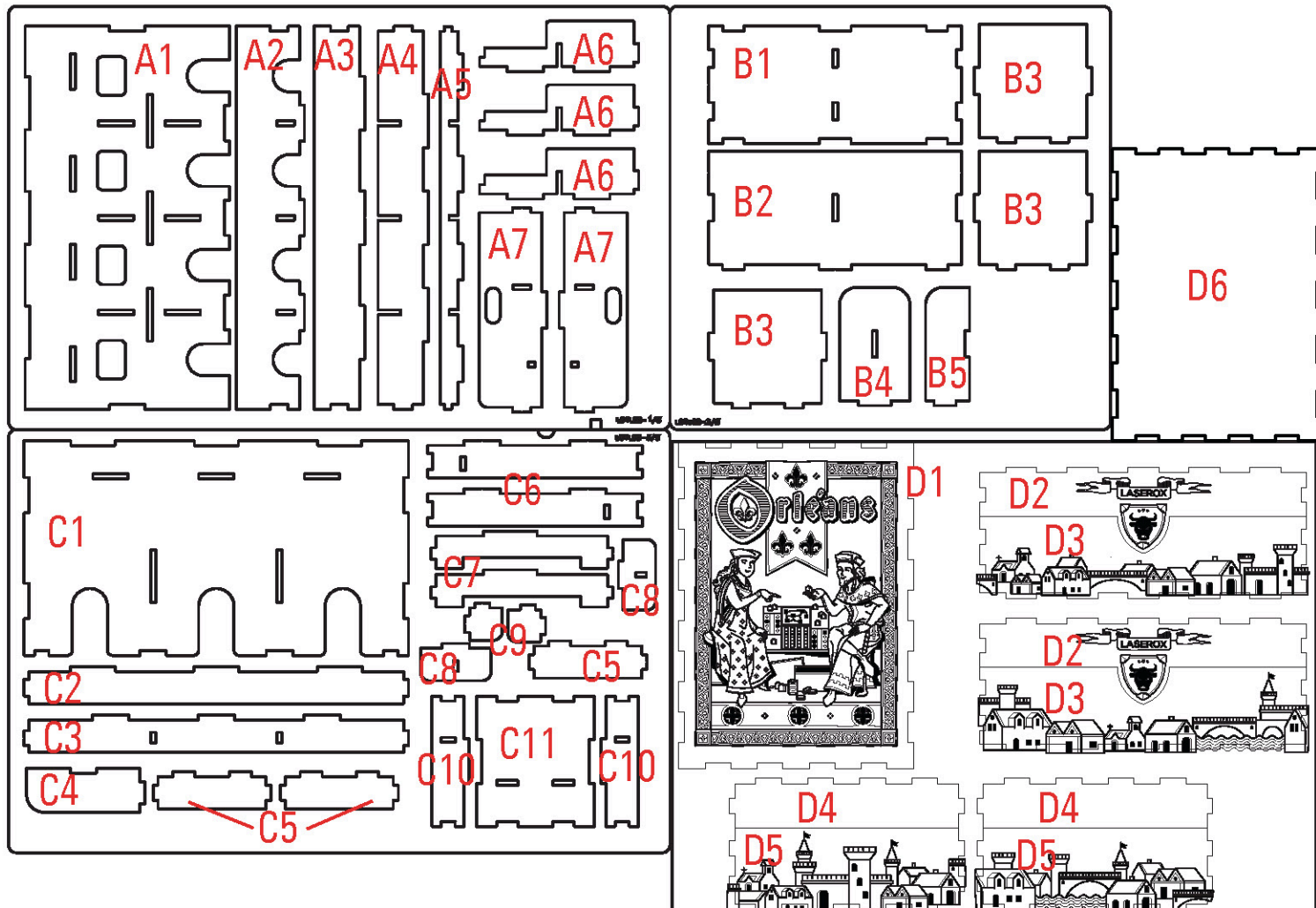

Round tiles

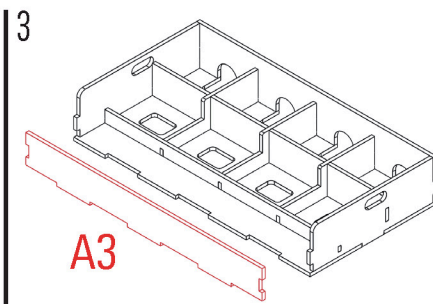
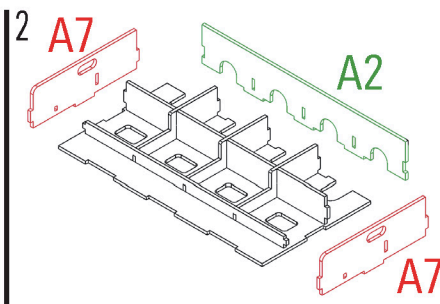
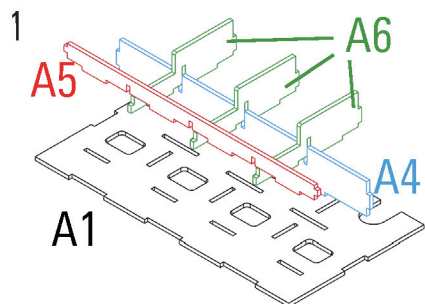

Required parts: **A1,A2,A3,A4,A5,A6x3,A7x2**

Buildings

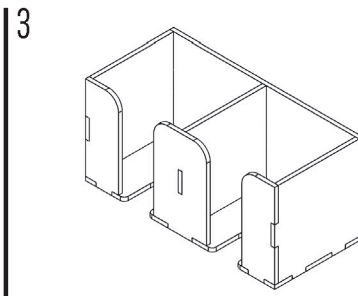
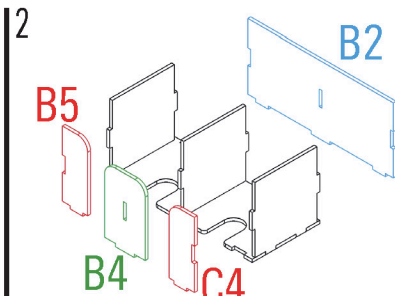
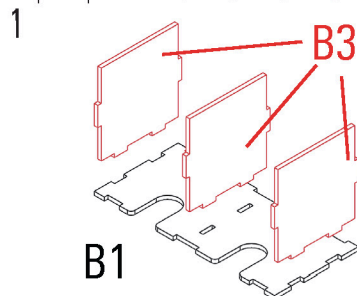

Required parts: **B1,B2,B3x3,B4,B5,C4**

Card tray

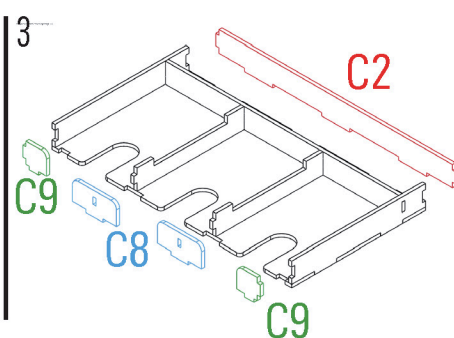
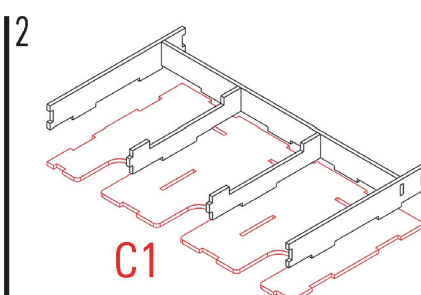
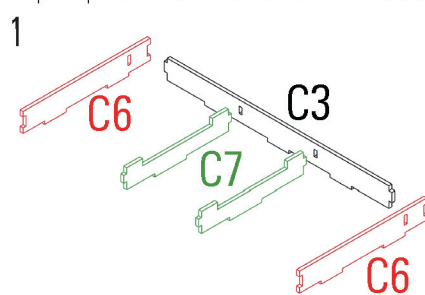

Required parts: **C1,C2,C3,C6x2,C7x2,C8x2,C9x2**

Token tray

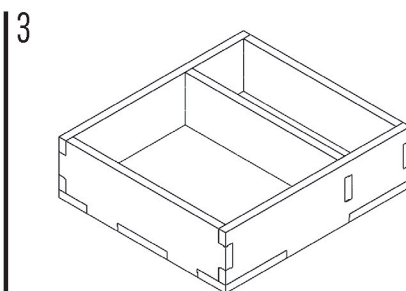
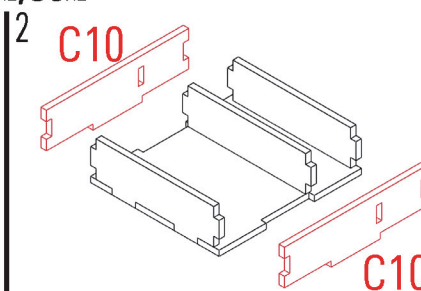
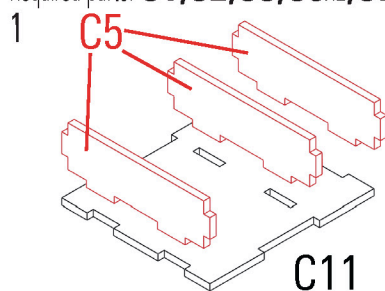

Required parts: **C5x3,C10x2,C11**

Big box

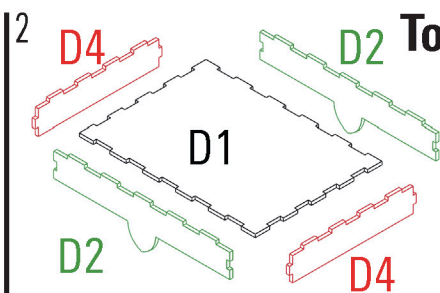
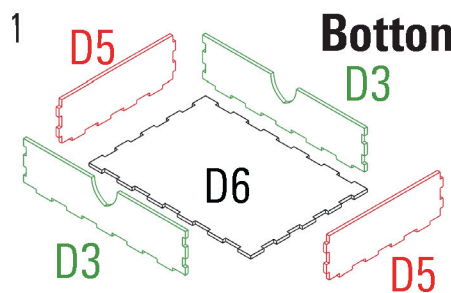

Make sure that all the engravings are facing outside!

Required parts: **D1,D2x2,D3x2,D4x2,D5x2,D6**

Assembly

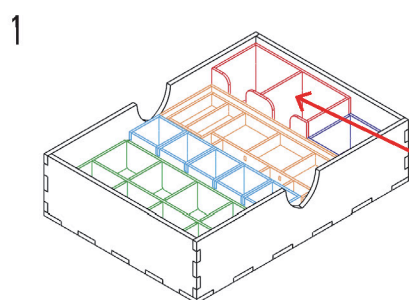

Use Base Game Organizer for the first layer, replace the **Building tray** with the new one, and put the rest on top.

