

# Viking Explorer Organizer

Compatible with Explorers of the North Sea®

and following expansions: EotNS: Rocks of Ruin  
EotNS: The Crew Mini-Expansion.

This product is not licensed and is up for change at any time in the future.



## Assembly Guide



**LASEROX**

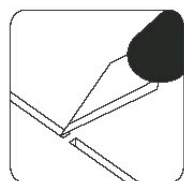

Use an exacto knife to cut the bits connecting the parts to the frame.

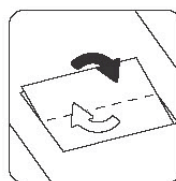

Remove the parts from the frame with a rotating motion along the axis formed by the bits you just cut.

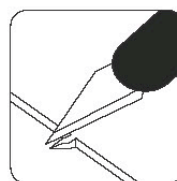

Use the exacto knife to remove any of the remaining connection bits.

Use **wood glue** for assembly. Always dry fit the parts first to make sure the components are correct ones. If you encounter any issues, please contact us at [info@laserox.net](mailto:info@laserox.net) or our Facebook page at [facebook.com/laseroxinserts](https://facebook.com/laseroxinserts).

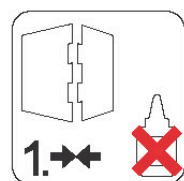

Always dry-fit the parts to together without any glue to make sure you are assembling the correct parts.

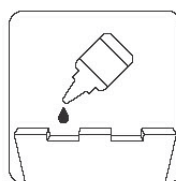

Use a drop of glue along the joints and hold it in place until the glue has sufficiently dried.

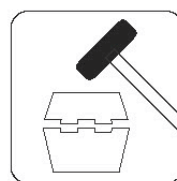

Press the parts together or use a hobby hammer with slight force for assembly.



5 999567 861481



**WARNING** Choking hazard!  
Not for children under 14 years.

## Part numbers

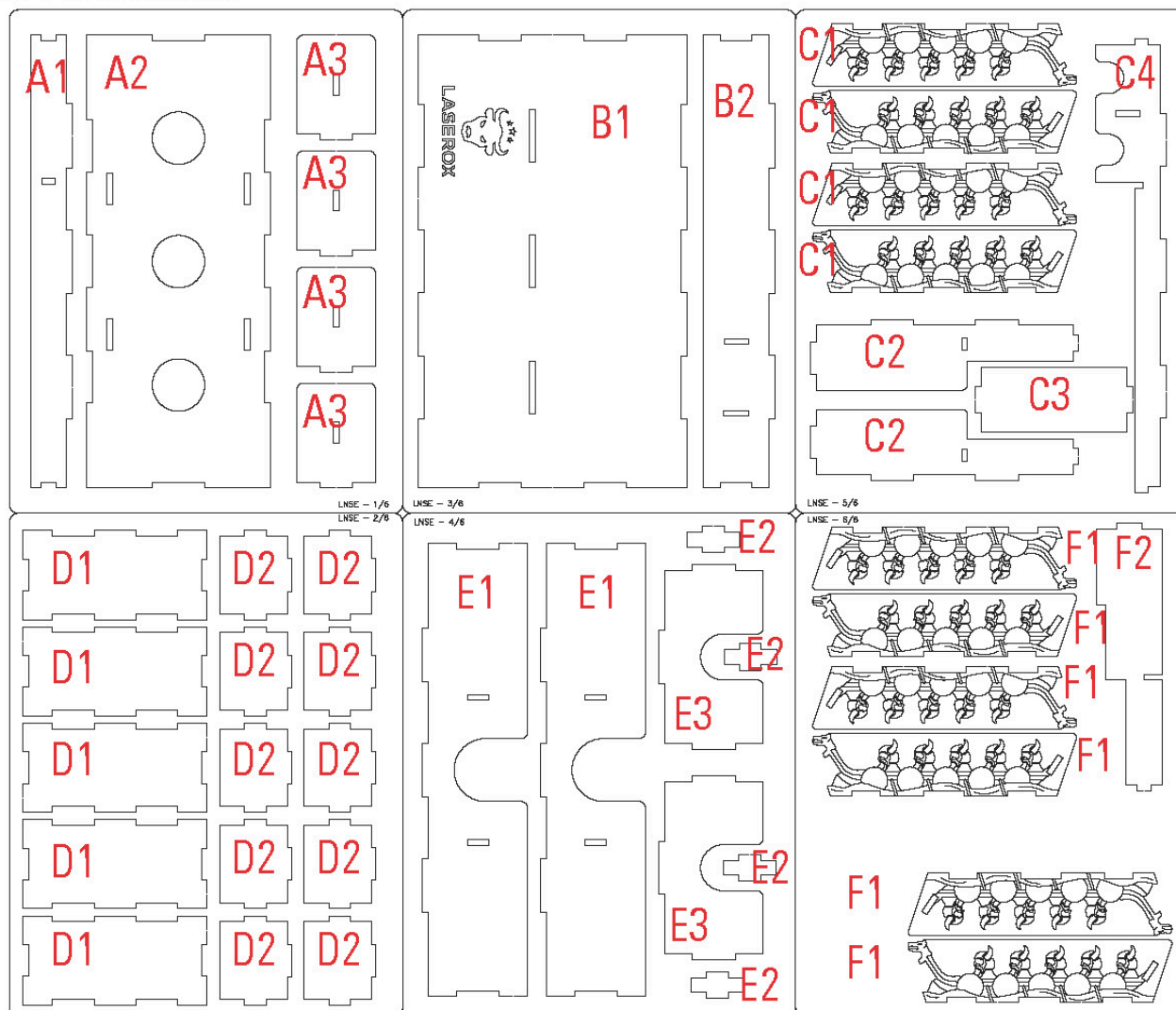

## Part 1. Player boat

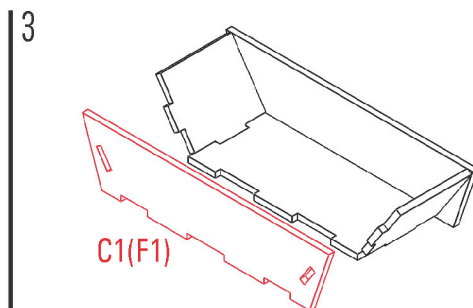
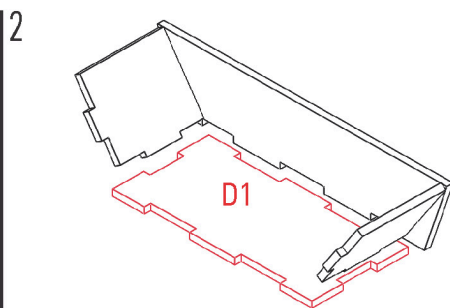
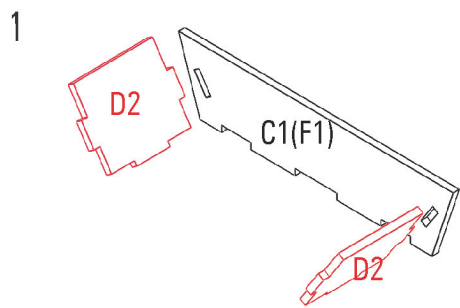

Required parts: **C1x4, F1x6, D2x10, D1x5**

## Assemble 5x

## Part 1. Tiles

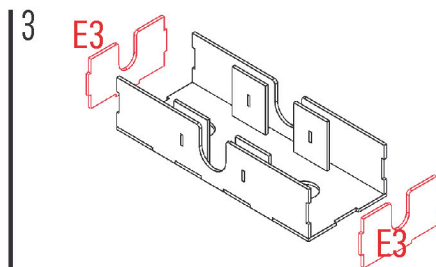
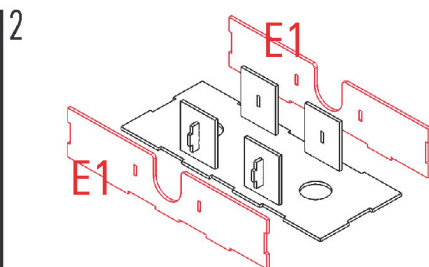
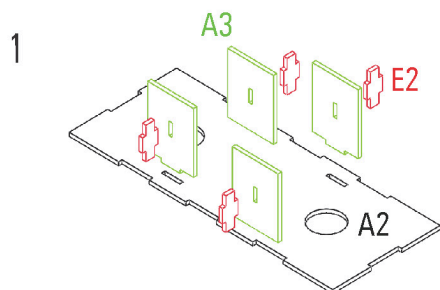

Required parts: **A2, A3x4, E2x4, E1x2, E3x2**

## Part 1. Token Tray

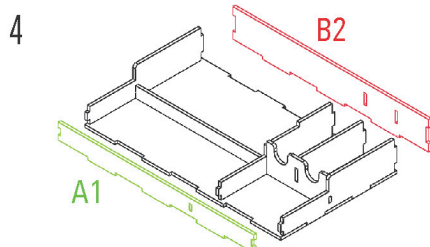
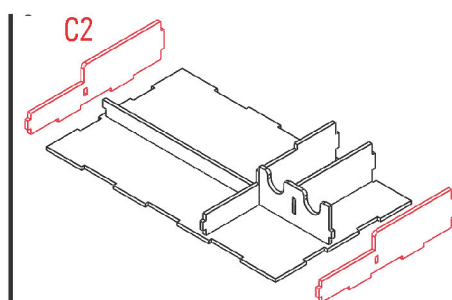
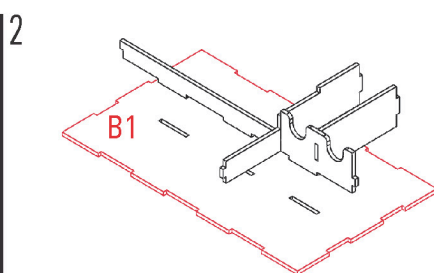
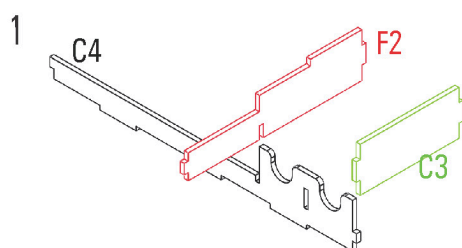

Required parts: **A1, B1, B2, C2x2, C3, C4, F2**

