

# Alpaca Storage

LALT

Compatible with Altiplano®  
& Altiplano: The Traveler®

This box organizer is compatible with Altiplano® & Altiplano: The Traveler®  
This product is licensed by dlp Games, and is up for change at any time in the future.



## Assembly Guide

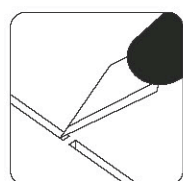

Use an exacto knife to cut the bits connecting the parts to the frame.

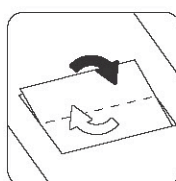

Remove the parts from the frame with a rotating motion along the axis formed by the bits you just cut.

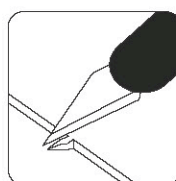

Use the exacto knife to remove any of the remaining connection bits.

Use **wood glue** for assembly. Always dry fit the parts first to make sure the components are correct ones. If you encounter any issues, please contact us at [info@laserox.net](mailto:info@laserox.net) or our Facebook page at [facebook.com/laseroxinserts](https://facebook.com/laseroxinserts).

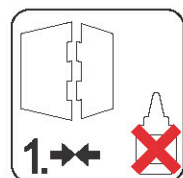

Always dry-fit the parts together without any glue to make sure you are assembling the correct parts.

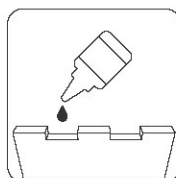

Use a drop of glue along the joints and hold it in place until the glue has sufficiently dried.

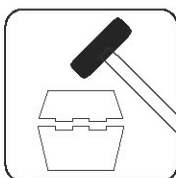

Press the parts together or use a hobby hammer with slight force for assembly.



**WARNING** Choking hazard!  
Not for children under 14 years.

## Part numbers

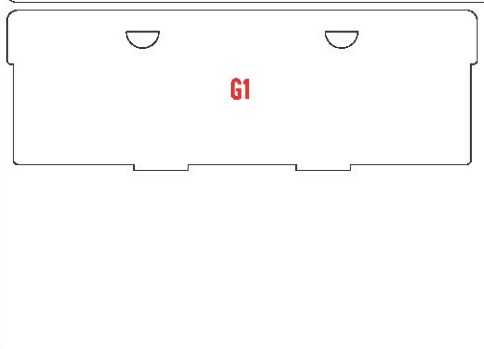
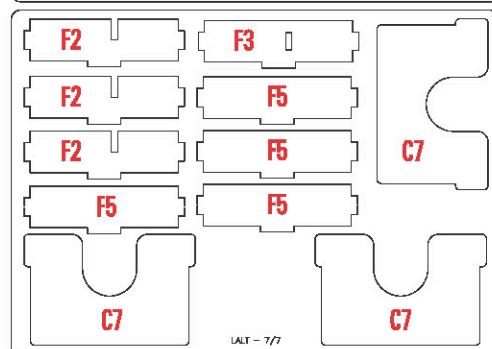
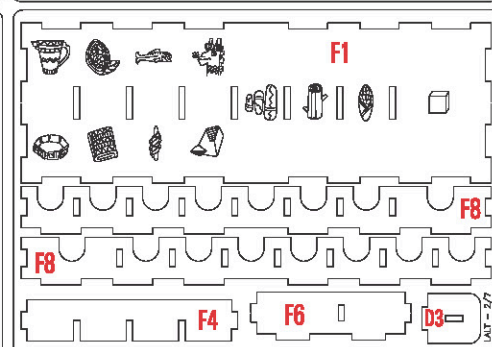
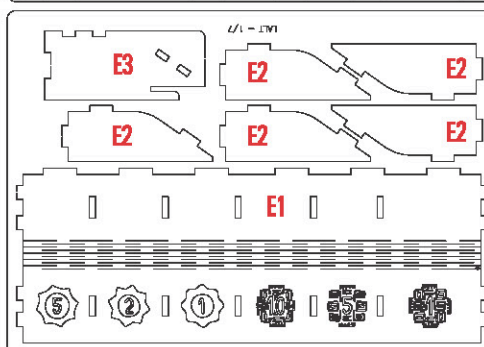
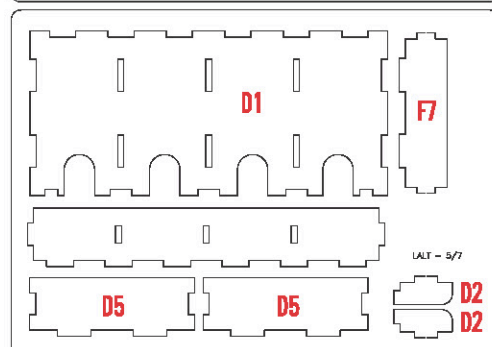
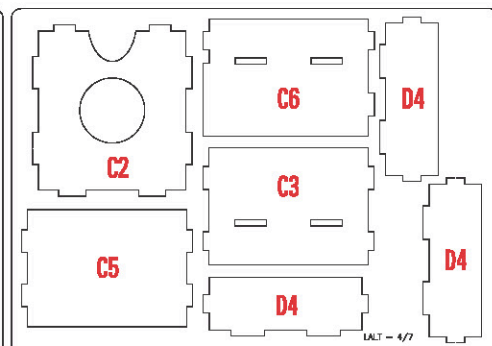
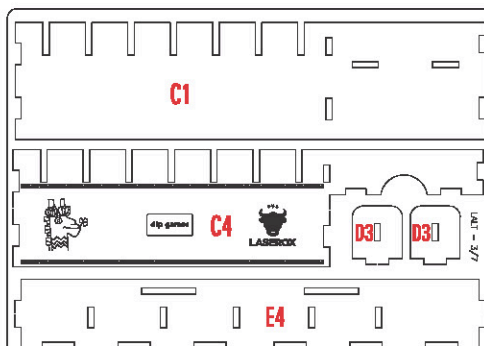
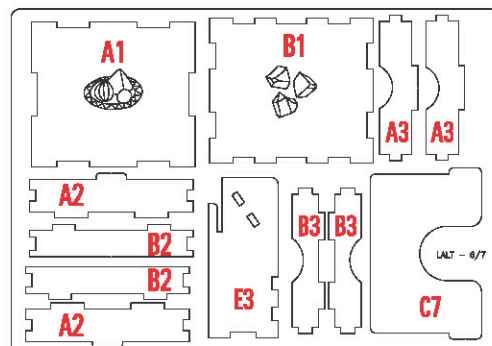

## Part 1. Gembox

1

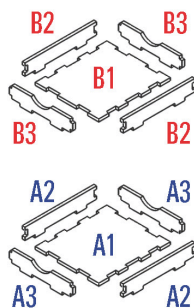

2

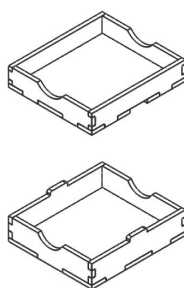

3

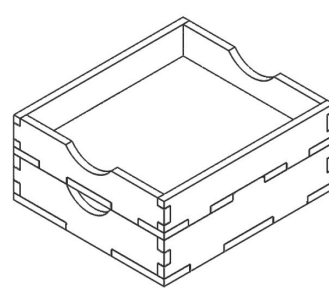

Required parts: **A1, A2x2, A3x2, B1, B2x2, B3x2,**

## Part 2. Card tray

1

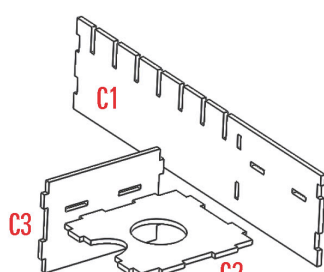

2

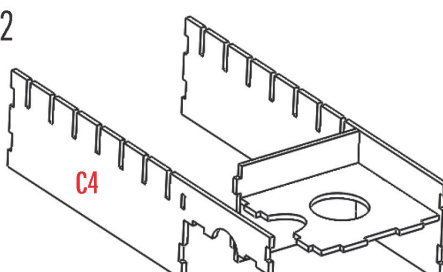

3

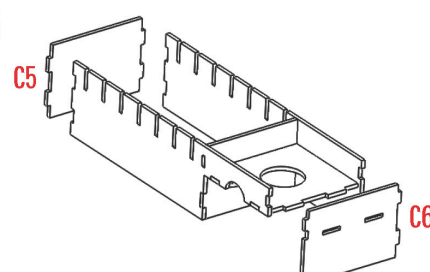

4

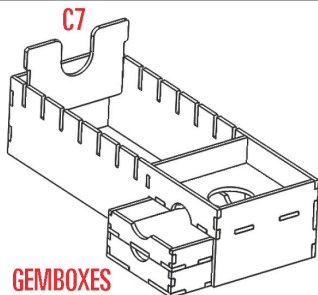

5

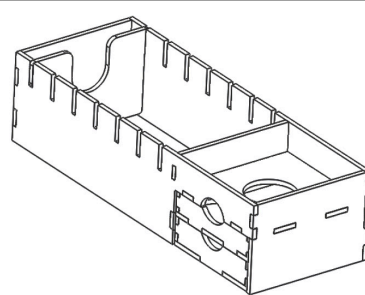

Required parts: **C1, C2, C3, C4, C5, C6, C7** + GEMBOXES

## Part 3. Extension

1

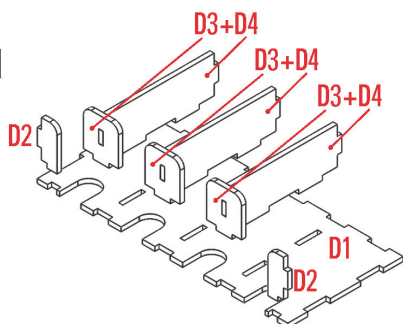

2

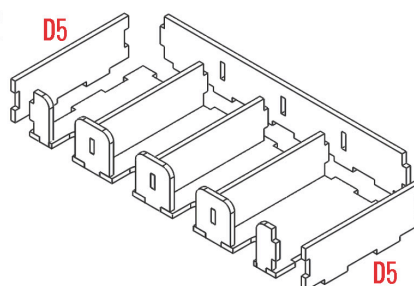

3

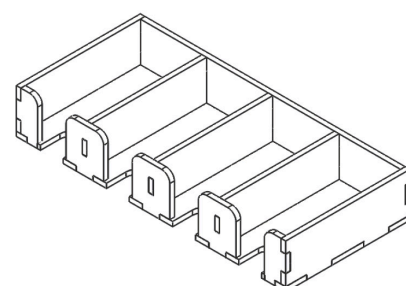

Required parts: **D1, D2x2, D3x3, D4x3, D5x2**

## Part 4. Coins

1

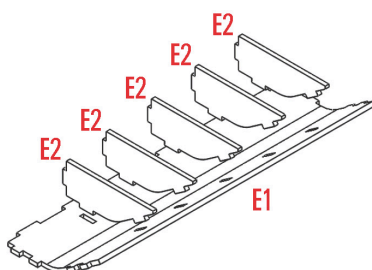

2

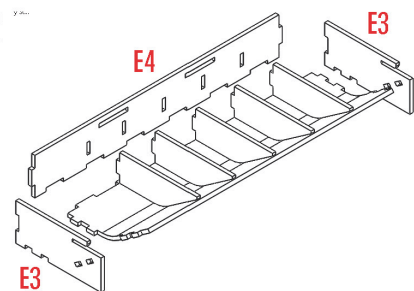

3

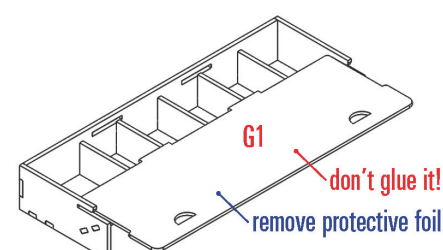

Required parts: **E1, E2x5, B4x2, PX3**



## Part 5. Resources

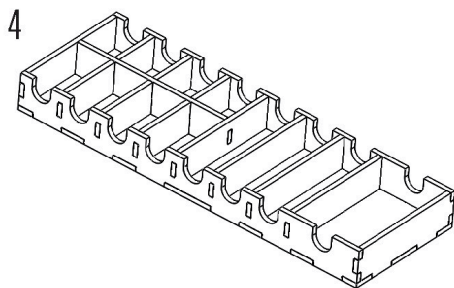
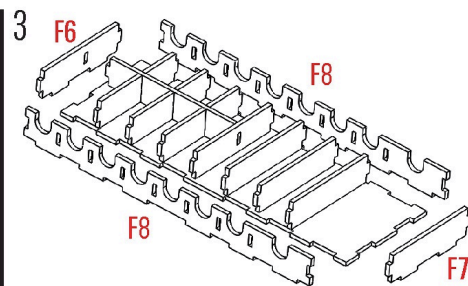
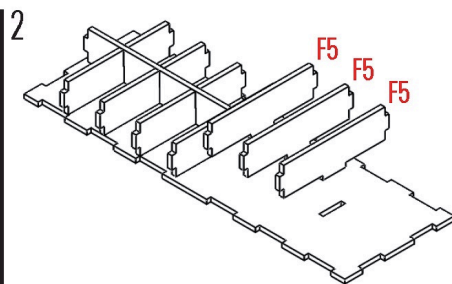
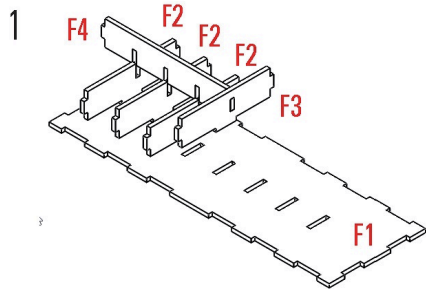

No problema!

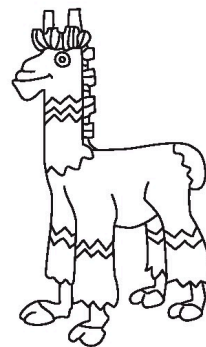

Required parts: **F1**, **F2x3**, **F3**, **F4**, **F5x3**, **F6**, **F7**, **F8x2**

## Box Assembly

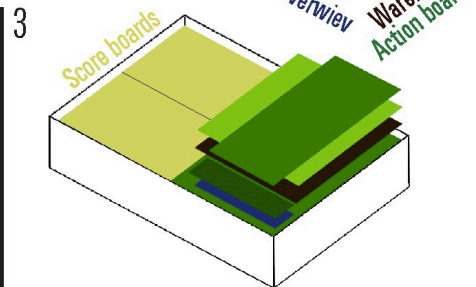
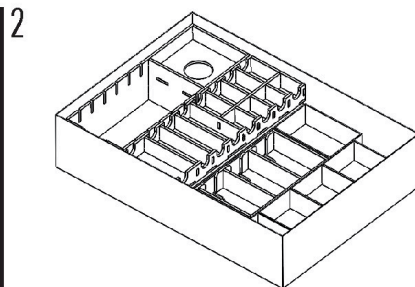
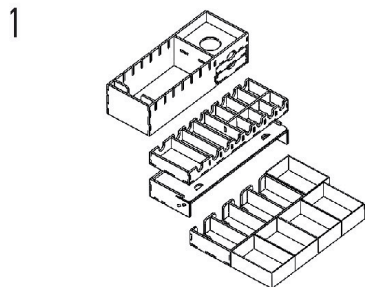

**We would like to extend our offer to you:**

